

Rest - Rotation Grazing System

PASTURE	1965			1966			1967			1968			1969																													
	JUL	AUG	SEP	OCT	NOV	DEC	JAN	FEB	MAR	APR	MAY	JUN	JUL	AUG	SEP	OCT	NOV	DEC	JAN	FEB	MAR	APR	MAY	JUN	JUL	AUG	SEP	OCT	NOV	DEC												
1 Antelope																																										
2 New Well																																										
3 Olga																																										
4 West Well																																										
5 CONT EST																																										

1965 1966 1967 1968 1969

1 2 3 4

1965 1966 1967 1968 1969

JUL AUG SEP OCT NOV DEC JAN FEB MAR APR MAY JUN JUL AUG SEP OCT NOV DEC

1965 1966 1967 1968 1969

1965 1966 1967 1968 1969

1965 1966 1967 1968 1969

1965 1966 1967 1968 1969

1965 1966 1967 1968 1969

1965 1966 1967 1968 1969

1965 1966 1967 1968 1969

1965 1966 1967 1968 1969

1965 1966 1967 1968 1969

1965 1966 1967 1968 1969

1965 1966 1967 1968 1969

1965 1966 1967 1968 1969

1965 1966 1967 1968 1969

1965 1966 1967 1968 1969

1965 1966 1967 1968 1969

1965 1966 1967 1968 1969

1965 1966 1967 1968 1969

1965 1966 1967 1968 1969

1965 1966 1967 1968 1969

1965 1966 1967 1968 1969

1965 1966 1967 1968 1969

1965 1966 1967 1968 1969

1965 1966 1967 1968 1969

1965 1966 1967 1968 1969

1965 1966 1967 1968 1969

1965 1966 1967 1968 1969

1965 1966 1967 1968 1969

1965 1966 1967 1968 1969

1965 1966 1967 1968 1969

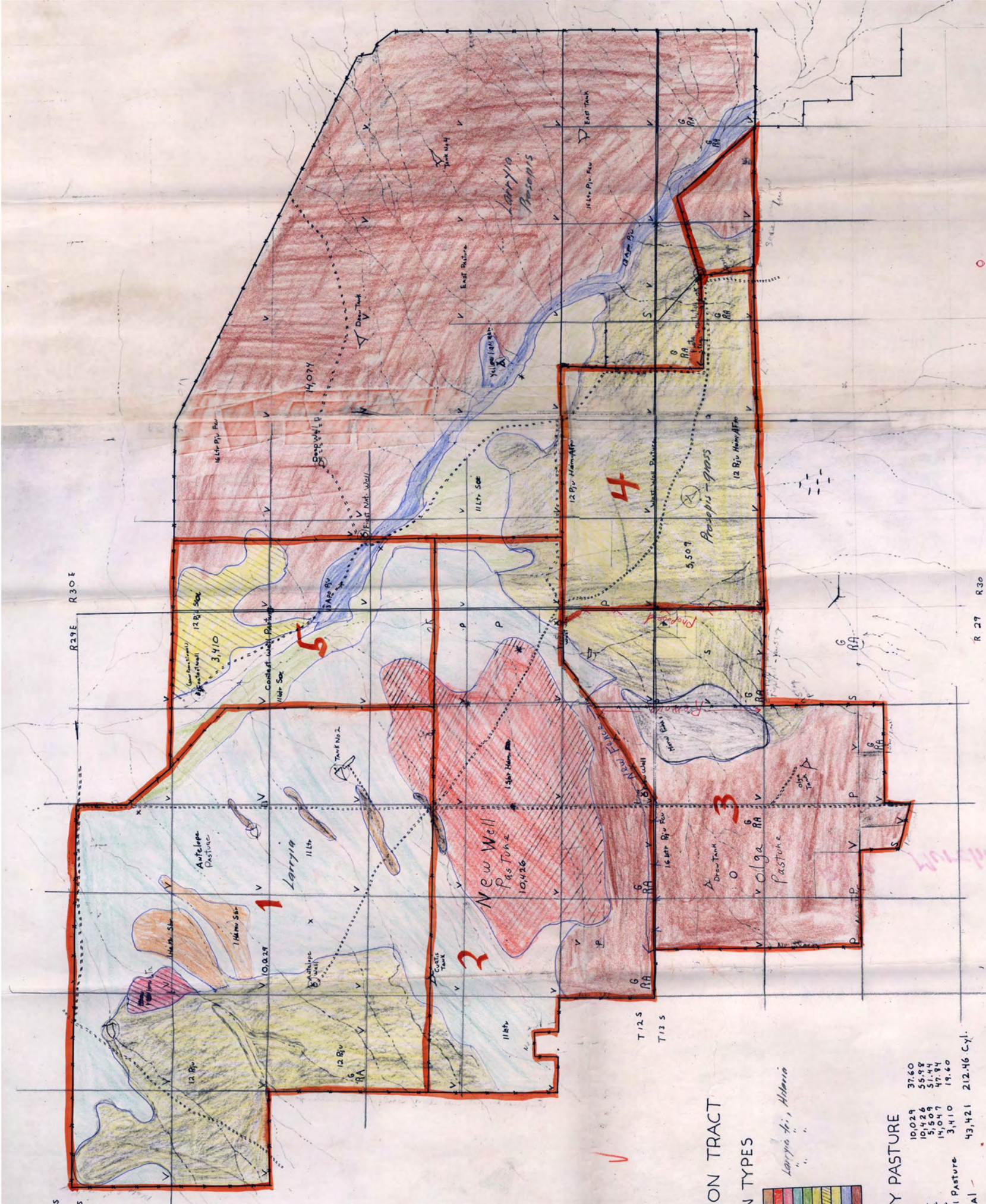

MURCHINSON TRACT

VEGETATION TYPES



ACREAGE BY PASTURE

Antelope Pasture	10,029	37.60
New Well Pasture	10,426	35.94
West Well Pasture	3,597	47.94
East Well Pasture	3,410	19.40
Contest		
Total	43,421	212.46 Cyl.

Adjusted Acreages

1 Antelope Pasture	10,029	37.60
2 New Well Pasture	6,706	33.00
3 West Well Pasture	4,309	35.00
4 Olga Pasture	4,920	39.00
5 Contest and Pasture	3,410	20.00
Est Pasture (Yanklong)	14,047	48.00
	43,421 A.	213 cyl.