

LYMAN RICHWINE SUMMER TOUR

The Fort Hall Indian Reservation was established by executive order issued on June 15, 1967 by Andrew Johnson.

Prior to that time, the history of Fort Hall is lined with tales of the old West.

In the summer of 1834, Nathaniel Wyeth built Fort Hall for the protection of his supplies and as a trading post. The original Fort Hall was located in the Fort Hall Bottoms on the east bank of the Snake River. It was named after Henry Hall who was the principal financial backer of Wyeth on his western expeditions. In 1836, the Hudson Bay Company bought Fort Hall and enlarged it.

Old Fort Hall became one of the chief trading posts of the west as well as a rendezvous for traders, trappers, and gold seekers. It was a very important stop for the wagon trains heading west on the Oregon Trail and south to the Santa Fe Trail. The abundance of feed and water in the Bottoms gave the road weary stock new life. The Oregon Trail entered what is now the Fort Hall Reservation at the southeast corner near where the Portneuf River leaves the Reservation. It followed Jeff Cabin Creek to the head of Ross Fork Creek, then down Ross Fork to the Bottoms and Fort Hall.

The U.S. Government signed a treaty on October 1, 1863, with the most noted chief of the Shoshone Tribe, Chief Washakie. The government agreed to set up a reservation sufficient for the Tribes needs. It was not until the Treaty of 1868, that the area was surveyed and definitely tied down. Meanwhile, the reservation has been reduced from the original 1,300,000 acres to its present size. The Fort Hall Indian Reservation now covers 523,000 acres of land consisting of bottom land, cultivated land, forested land and open grazing land.

Open grazing and timber types cover 325,481 acres. There are 7,696 cattle and 20,269 sheep that make up 57,324 animal unit months grazed on reservation range land. Average stocking rate for the Reservation is 5.7 acres per animal unit month.

Reservation range land is allocated to Indian livestockmen at the rate of \$1.25 per AUM for allotted land and \$.80 per AUM for Tribal land. The Shoshone-Bannock Tribes contribute \$.10 for Indian used AUM's into a range improvement maintenance fund. Surplus grazing on the Reservation is advertised for competitive bidding to non-Indians. Non-Indians are currently paying an average of \$1.25 per AUM plus \$.25 an AUM for range improvement maintenance.

The Bannock Creek range unit is permitted to the Bannock Creek Stockmen's Association (Indian), and the Arbon-Rockland Cattlemen's Association (non-Indian) for 1800 head of cattle. The Arbon-Rockland Cattlemen's Association, through competitive bidding has acquired all the AUM's not used on the range unit by Indian cattle.

Both Associations cooperate on all business matters concerning the members. A Bull Grading Committee with members of each Association grade all bulls before they go to the range. Bulls that grade below "B" are disqualified. Work projects are completed on a cooperative basis between the Associations. The Cable Corral and the famous Bannock Creek Cabin are products of their combined effort.

The Bannock Creek Range Unit consists of seven sub-grazing units. The sub-units named and numbered on the attached map are Unit 22, Birch Creek - Rattlesnake, Cedars, Starlite, Catchment, Bannock Peak, and West Fork containing 75,989 acres and 1800 head of Cattle.

The units are managed under a rest-rotation system of management. The grazing formula includes all seasons of grazing.

Unit 22.

Unit 22 has had a long history of Spring and Fall sheep grazing. The Unit was combined with the Bannock Creek range unit at the beginning of the 1967 grazing season to provide for increasing cattle numbers. As a result of its long history of sheep use, forbs are in trace amounts on the unit with an abundance of needle thread grass (*Stipa comata*). Improvement of the unit has been demonstrated with an increasing frequency of Blue bunch wheat-grass (*Agropyron spicatum*). This year the unit is being used as the association calf pasture. There were 470 head of "calvy cows" turned on the unit at the beginning of the grazing season. Branding, marking, and castrating of slick calves was completed in a minimum of time without disturbing the bulk of the cows.

Birch Creek - Rattlesnake Sub-unit.

This unit will be rested this year.

West Fork sub-unit.

This sub-unit was overstocked and serious plant regression took place. Vegetation consisted mainly of Rabbit Brush, cheat grass, and big sage brush so high that a tall man on a tall horse could lose a herd of cows in the sage brush thicket. A wild fire in the fall of 1966 caused an emergency reseeding of crested wheat grass

in the burned area. In the fall of 1968, the rest of the poor condition range land was treated. Before treatment of this area, the stocking rate was 20 acres per AUM. Be pleased to make your own observation as to present stocking rate.

Bannock Creek Stockmen will use the sub-unit for winter grazing this year. By feeding protein supplement and grazing, the Bannock Creek Stockmen have been able to cut winter feeding costs considerably.

Old Bannock Creek Homestead

Cedars Subunit.

This sub-unit was scheduled to be grazed last spring, but due to water problems the unit was rested. This year the unit will be used for fall grazing, which consistent with rest-rotation grazing will be planting time. Notice good understorey of grass under Juniper overstorey.

Cable Corral (Starlite sub-unit)

Cable Corral is the combined result of the efforts of the Bannock Creek and Arbon-Rockland Cattlemen working together. The Starlite sub-unit was stocked at about 4.2 acres/AUM this year. You will notice the uniformity of utilization on all species present. In the fall of 1965, about 2500 acres were sprayed with 2,4-D to control low larkspur. The Arbon-Rockland Cattlemen's Association and the B.I.A. shared the cost of the spraying.

Lunch Stop at Corral Springs.

The Bannock Creek Cabin is another example of the cooperative spirit that exists between the Arbon-Rockland Cattlemen's Association and the Bannock Creek Stockmen.

Bannock Peak

Bannock Peak is used for summer range every year. Cows are held off summer range until July thus deferring the grass most years. Cattle were put on the peak early this year due to a lack of feed in the Starlite unit.

Catchment Sub-unit.

This sub-unit was named after a water catchment area. As yet, water in sufficient amounts has not been stored to get best utilization of the unit. In order to utilize the unit fully, a well is being drilled on top of the high ridge on the north boundary of the unit. From this point water could be piped to most dry areas of the unit.

BANNOCK CREEK ROTATION SYSTEM

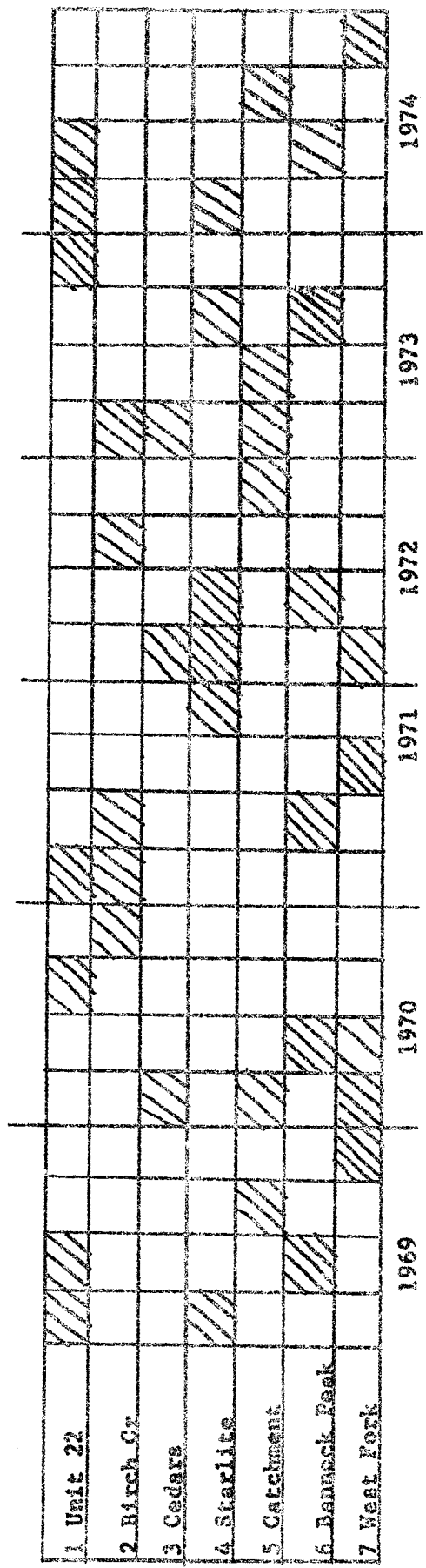

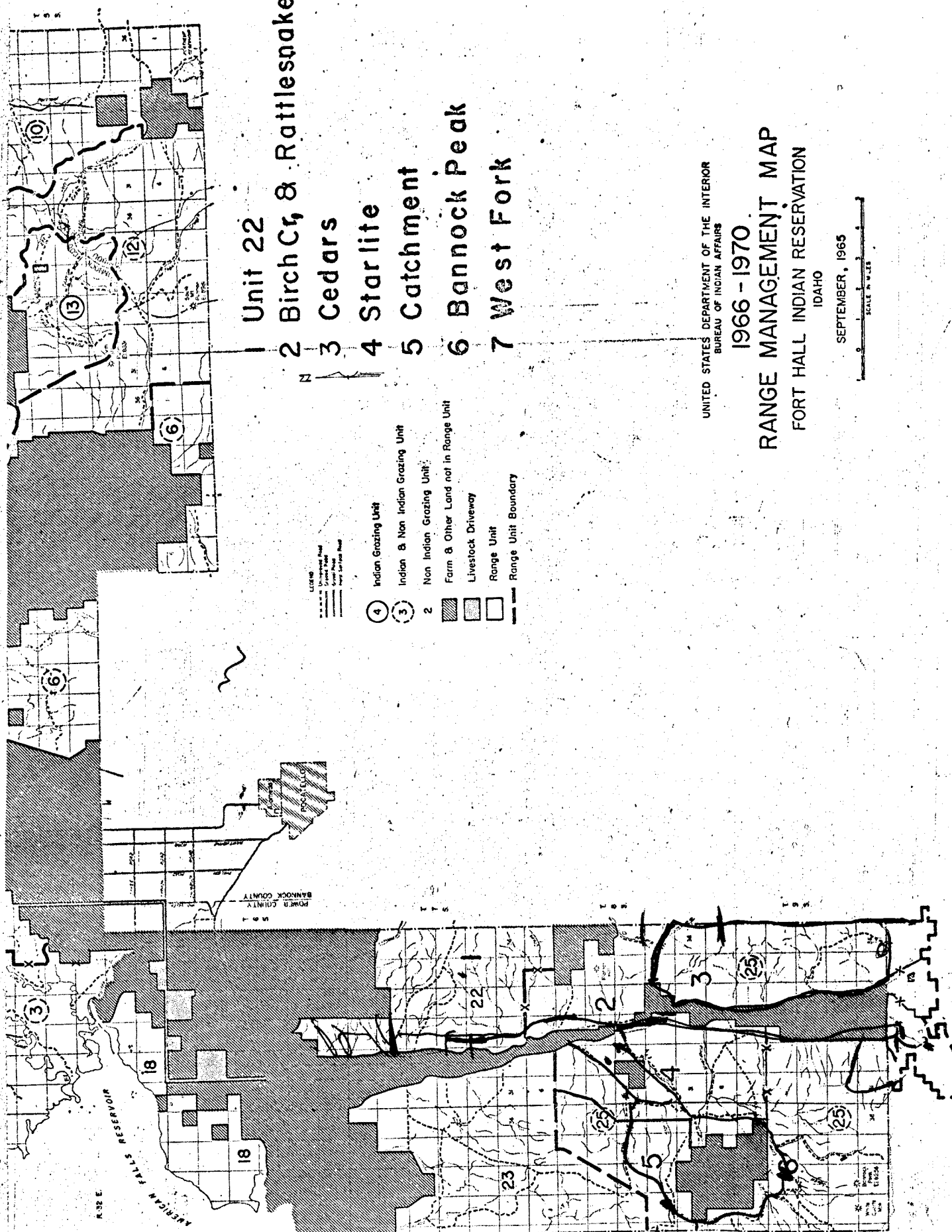

Unit 22
 2 Birch Cr, & Rattlesnake

3 Cedars

4 Starlite

5 Catchment

6 Bannock Peak

7 West Fork

- LEGEND**
- Indian Grazing Unit
 - Indian & Non Indian Grazing Unit
 - Non Indian Grazing Unit
 - Farm & Other Land not in Range Unit
 - Livestock Driveway
 - Range Unit
 - Range Unit Boundary

UNITED STATES DEPARTMENT OF THE INTERIOR
 BUREAU OF INDIAN AFFAIRS

1966 - 1970

RANGE MANAGEMENT MAP

FORT HALL INDIAN RESERVATION
 IDAHO

SEPTEMBER, 1965

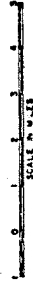

1970

| | | | | | | | | | |
|------------------|-----|-----|-----|-----|-----|-----|--|-----|-----|
| Stevens Peak ✓ | /// | | | | | | | | |
| Buckskin Basin ✓ | | | | | | | | /// | /// |
| Gardell Mt. ✓ | | /// | /// | | | | | | |
| Dunn Basin | | | | | /// | /// | | | |
| Higham Peak ✓ | | | | /// | /// | | | | |
| Portneuf | | | | | | | | | |

Rest

1971

| | | | | | | | | | |
|----------------|-----|-----|-----|-----|-----|-----|--|-----|-----|
| Stevens Peak | /// | | | | | | | | |
| Buckskin Basin | | | | | | | | /// | /// |
| Gardell Mt. | | /// | /// | | | | | | |
| Dunn Basin | | | | | | | | | |
| Higham Peak | | | | | /// | /// | | | |
| Portneuf | | | | /// | /// | | | | |

Rest

1972

| | | | | | | | | | |
|----------------|-----|-----|-----|--|-----|-----|-----|-----|-----|
| Stevens Peak | /// | | | | | | | | |
| Buckskin Basin | | | | | | | | /// | /// |
| Gardell Mt. | | | | | | | | | |
| Dunn Basin | | | | | | | /// | /// | |
| Higham Peak | | | | | /// | /// | | | |
| Portneuf | | /// | /// | | | | | | |

Rest

1973

Stevens Peak
Buckskin Basin
Gardell Mt
Dunn Basin
Higham Peak
Portneuf



1974

Stevens Peak
Buckskin Basin
Gardell Mt.
Dunn Basin
Higham Peak
Portneuf

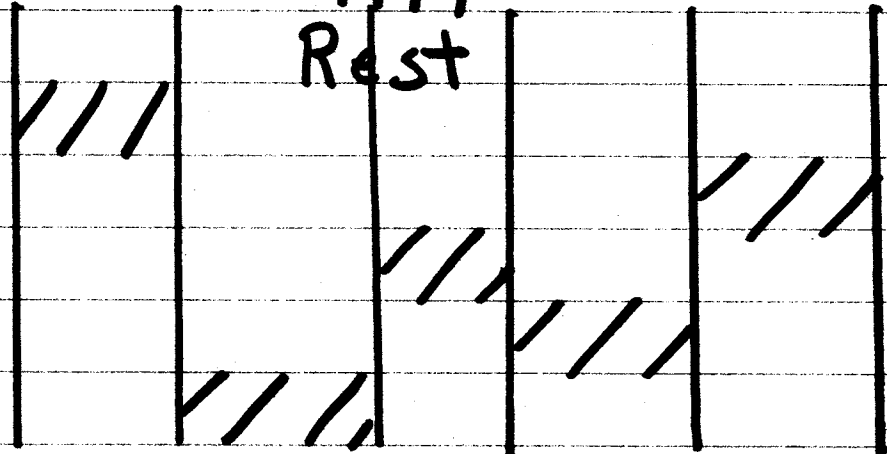

1975

Stevens Peak
Buckskin Basin
Gardell Mt.
Dunn Basin
Higham Peak
Portneuf

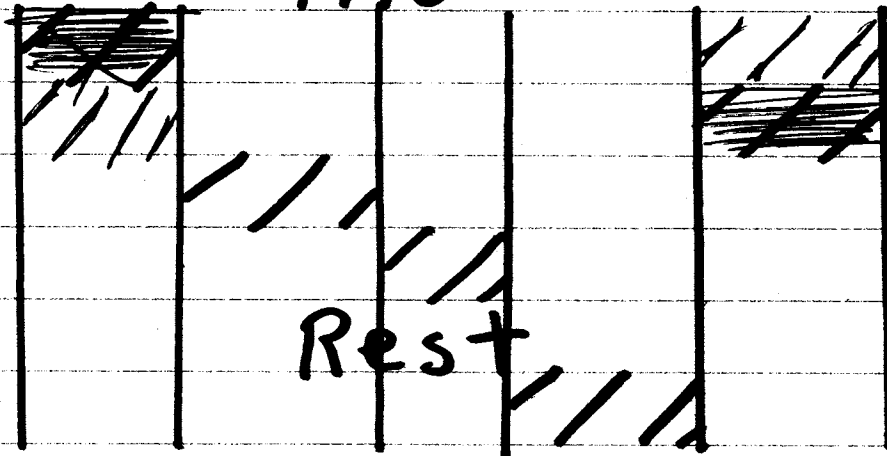

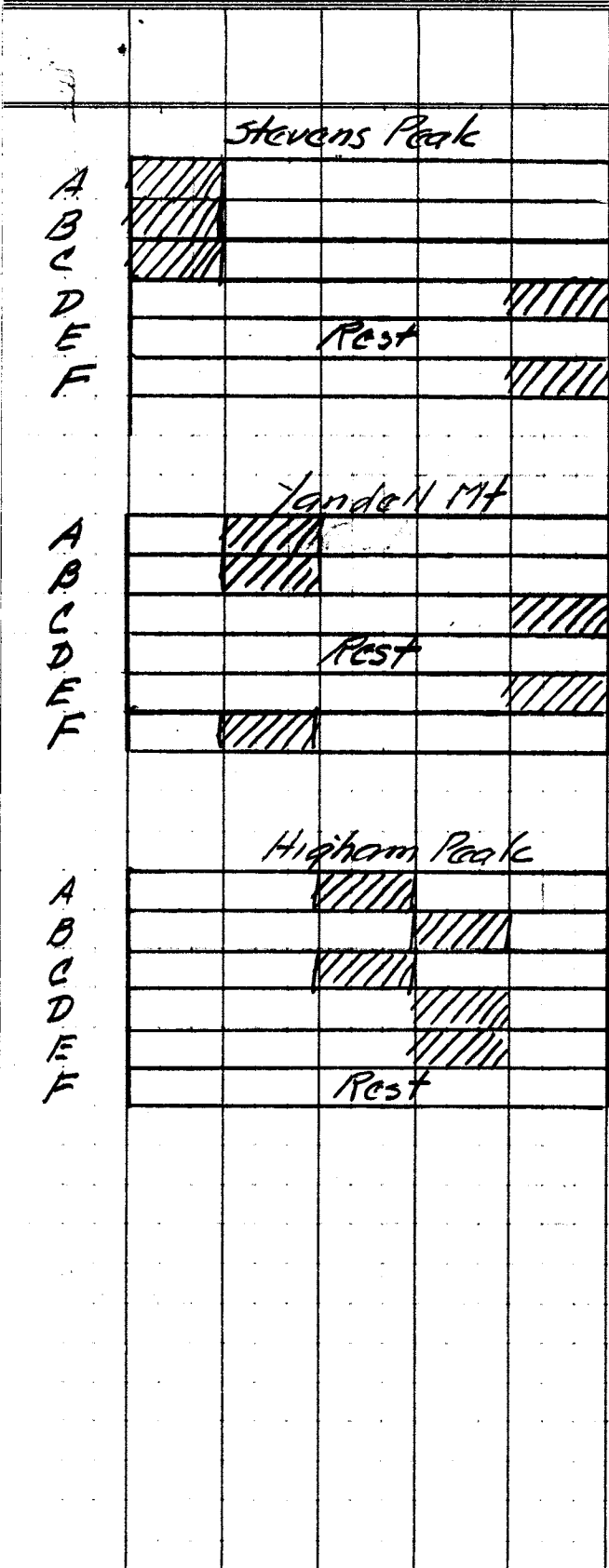

1970
71
72
73
74
75

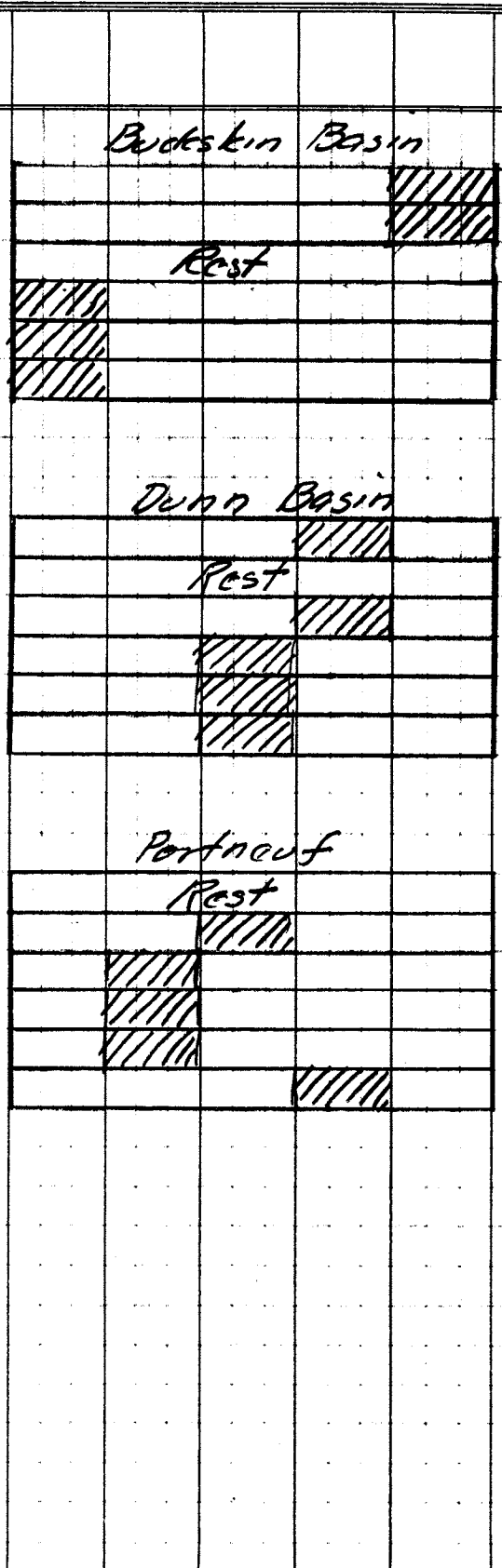

1970
71
72
73
74
75

1970
71
72
73
74
75

Buckskin Basin
Spring

Stevens Peak
Spring

Gardell Mt.

Intermedia

Summer
Rtneuf River

Summer
Higham Peak

Summer
Dunn Basin

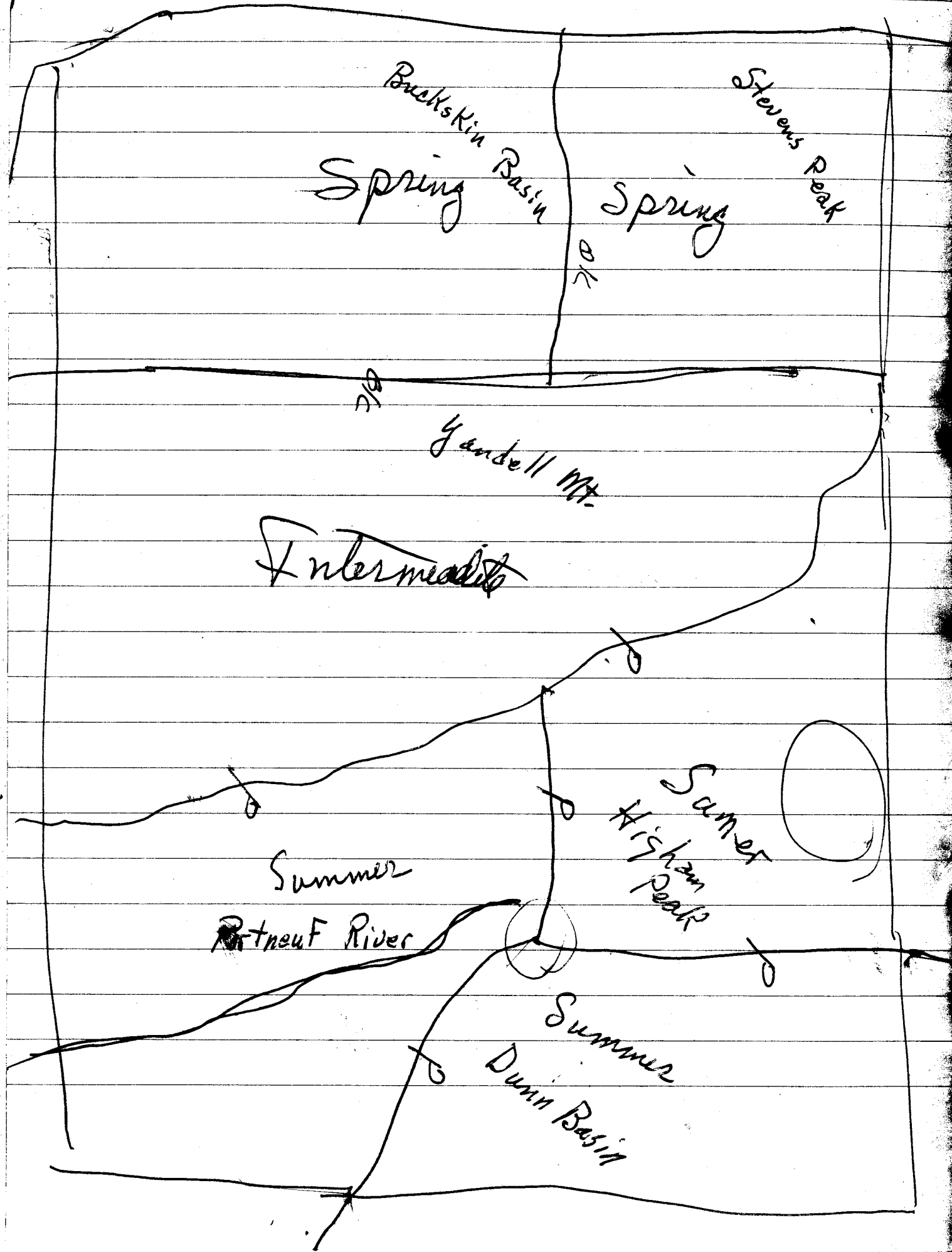

Fort Hall Indian Reservation
North Mt Pelman - Portneuf Res-
ervoir Unit.

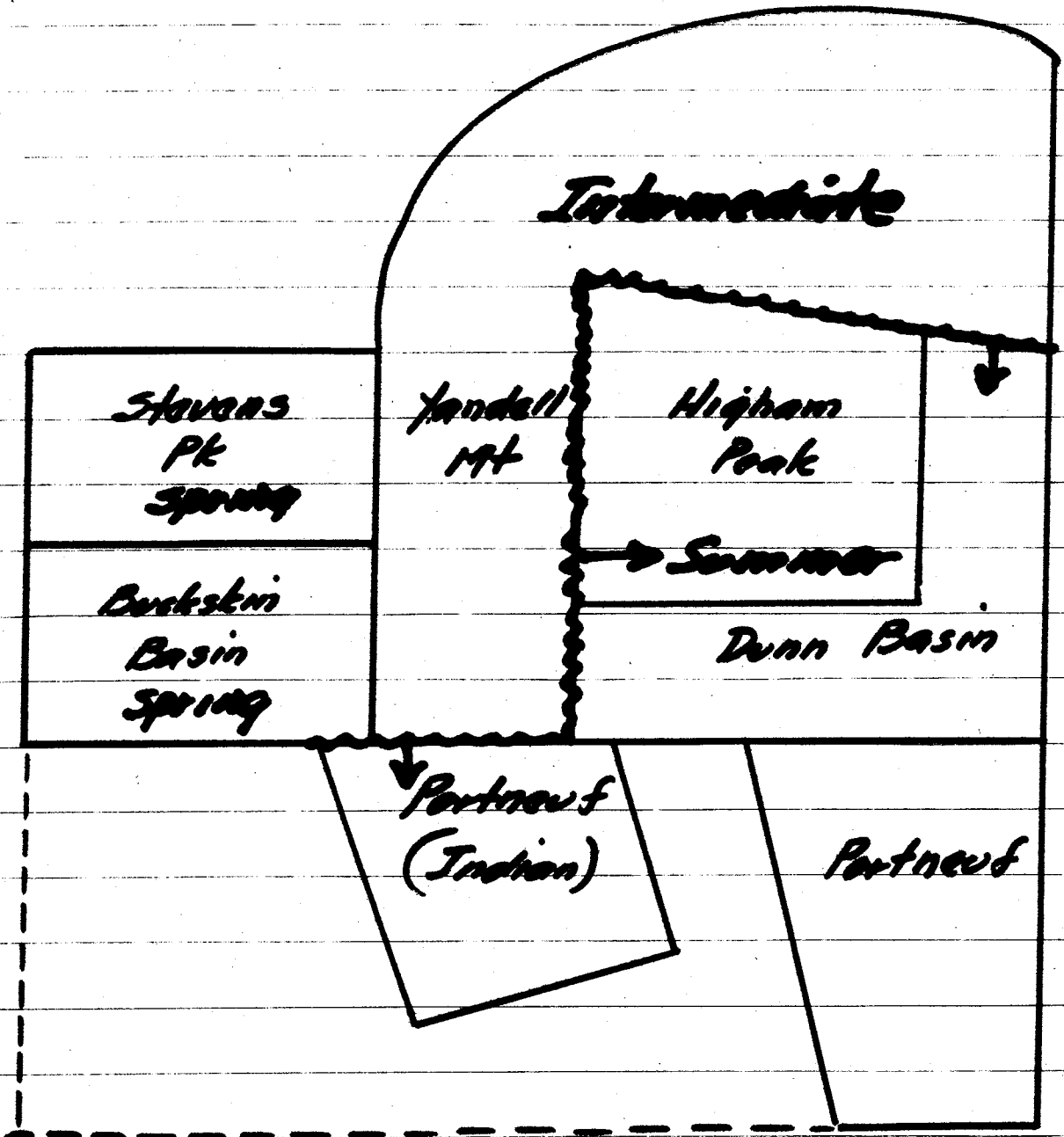

Fort Hall Indian Reservation

Bannock Crk

Idaho

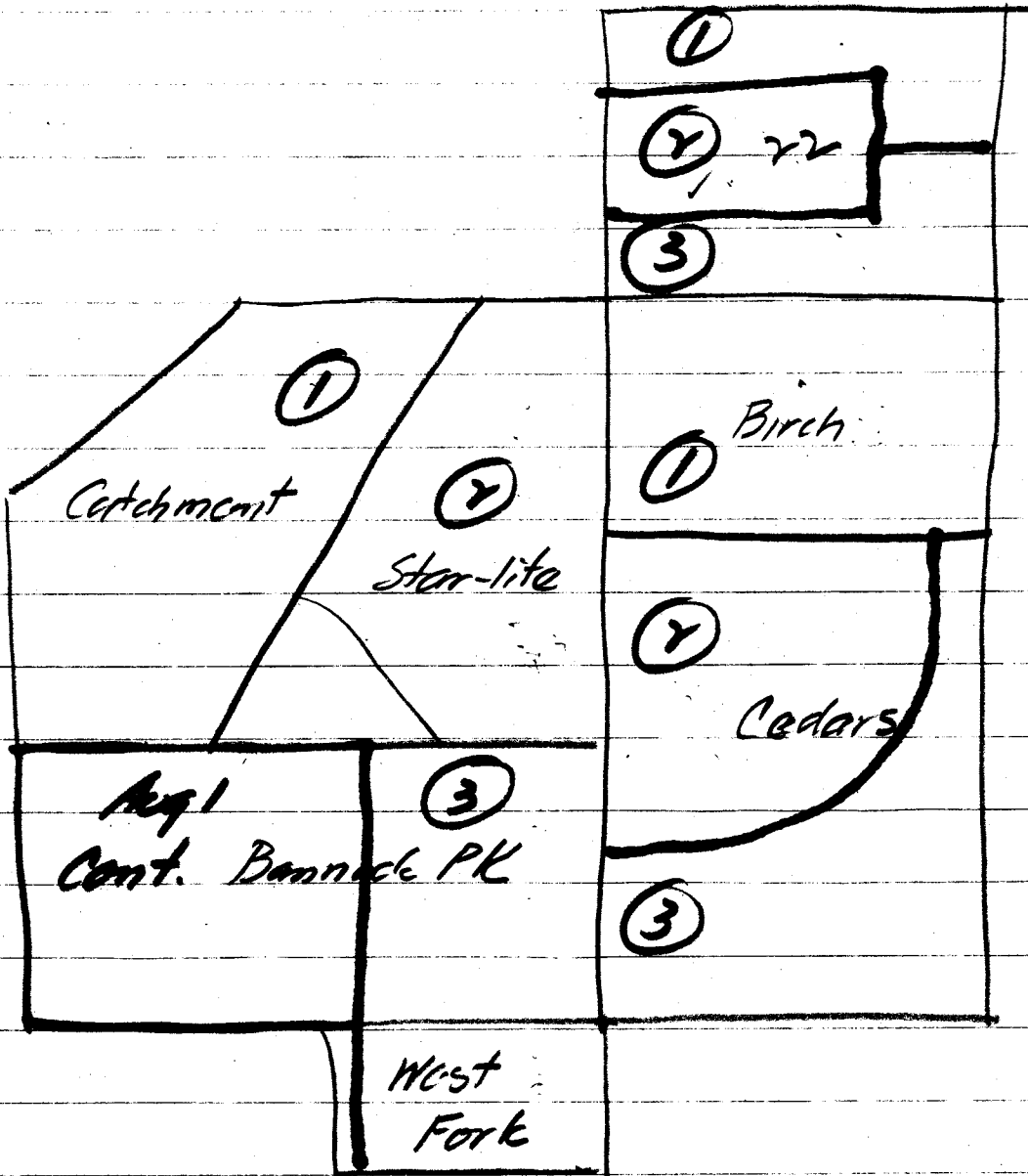

Unit 72

Birch Crk

A
B
C
D
E
F

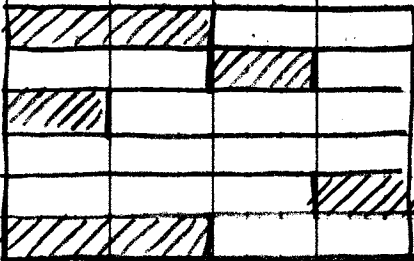

Cedars

Starlite

A
B
C
D
E
F

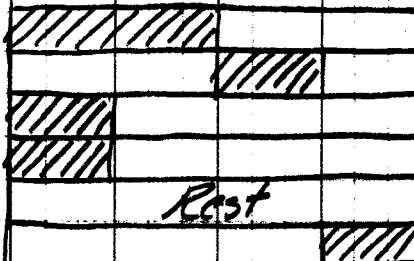
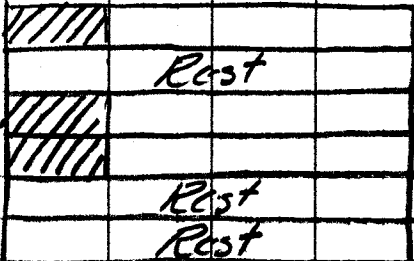

Catchment

Bannock Plc

A
B
C
D
E
F

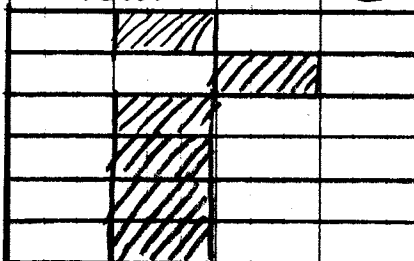
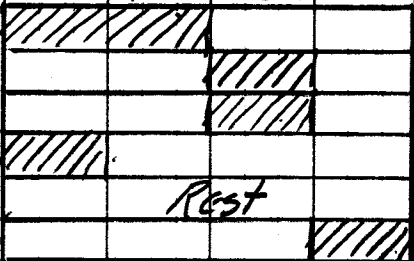

West Fork

A
B
C
D
E
F

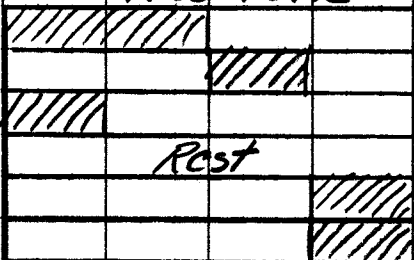

Bannock Creek

Cedars

Starlite

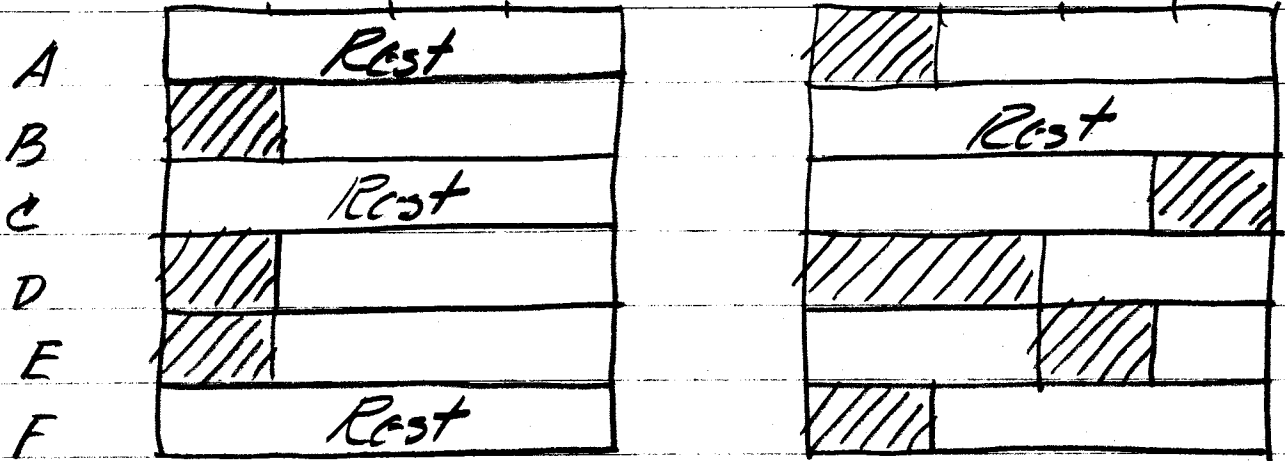

Catchment

Bannock Peak

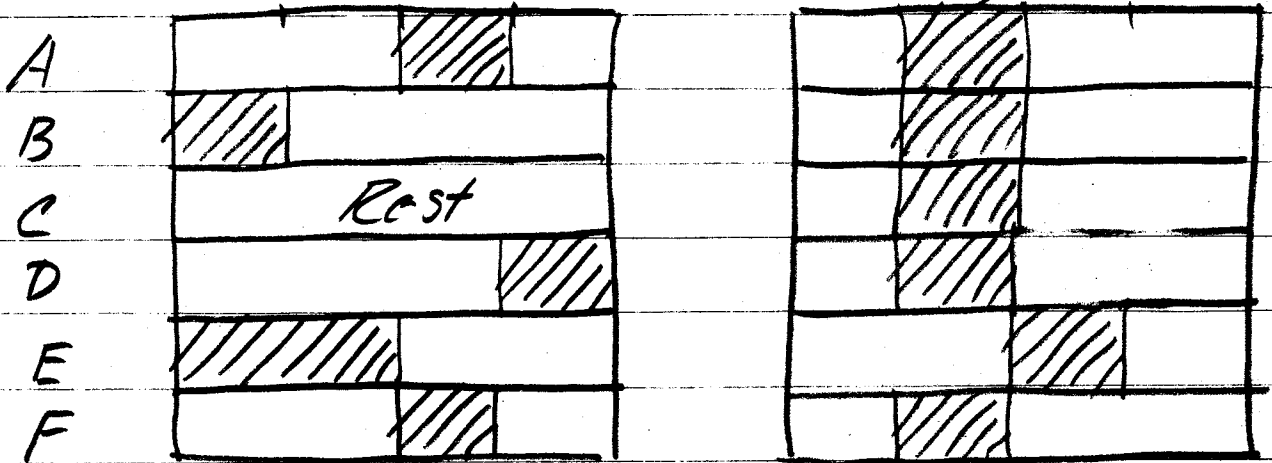

West Fork

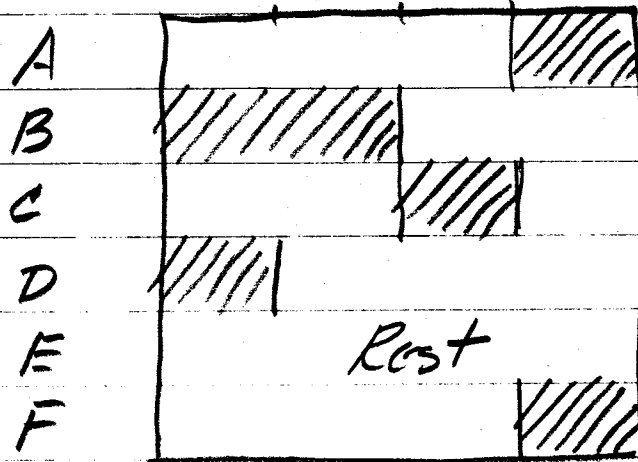

Bannock Creek

Unit 22

July 1

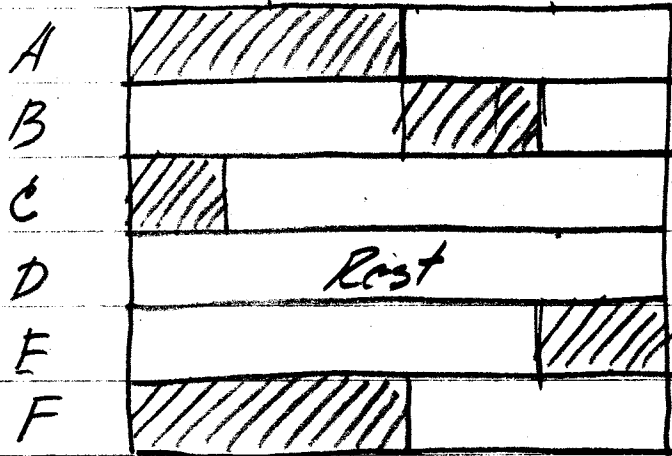

Birch Crk.

