

State Colorado
District Canon City #5
Allotment Name Cisneros

Date 4/4/67

STATUS OF REST-ROTATION GRAZING ALLOTMENTS

Supplemental information on each rest-rotation allotment:

1. Is the rest-rotation system in operation? Yes No .
2. Date of start of first grazing season 5-21-66.
(Actual date for allotments under management. Planned date for allotments not yet in operation.)
3. Is the form of management in effect or to be applied the same as the one reviewed or suggested by Mr. Hormay?
Yes No . * If not, supply the following information:
 - a. Diagram of grazing formula in use or planned.
 - b. Map showing pasture layout.
 - c. Map diagrams showing movement of livestock between pastures for one grazing cycle.

In cases where rest-rotation grazing has been in effect for one year or more, please comment briefly on the prospects, merits or deficiencies of the system. It is a little too early to fully judge the system, but your comments will be helpful in pointing up future grazing training programs.

Although our phototrend plots are now in the process of being established, visual observations point out a considerable increase in the volume and density of grass growth. We believe cattle use in the allotment will be advisable by the end of the 3rd year of the cycle. Utilization, as a result of herderless sheep use, is not uniform. We believe salting and bedding changes will alleviate this problem to a large degree. Our biggest complaint is the overabundance of sheep trails now in evidence as a result of herderless management.

*Mr. Hormay's proposed treatments of pastures C and D were reversed because water had not been developed in "D" at the initiation of the system.

Encl. 1

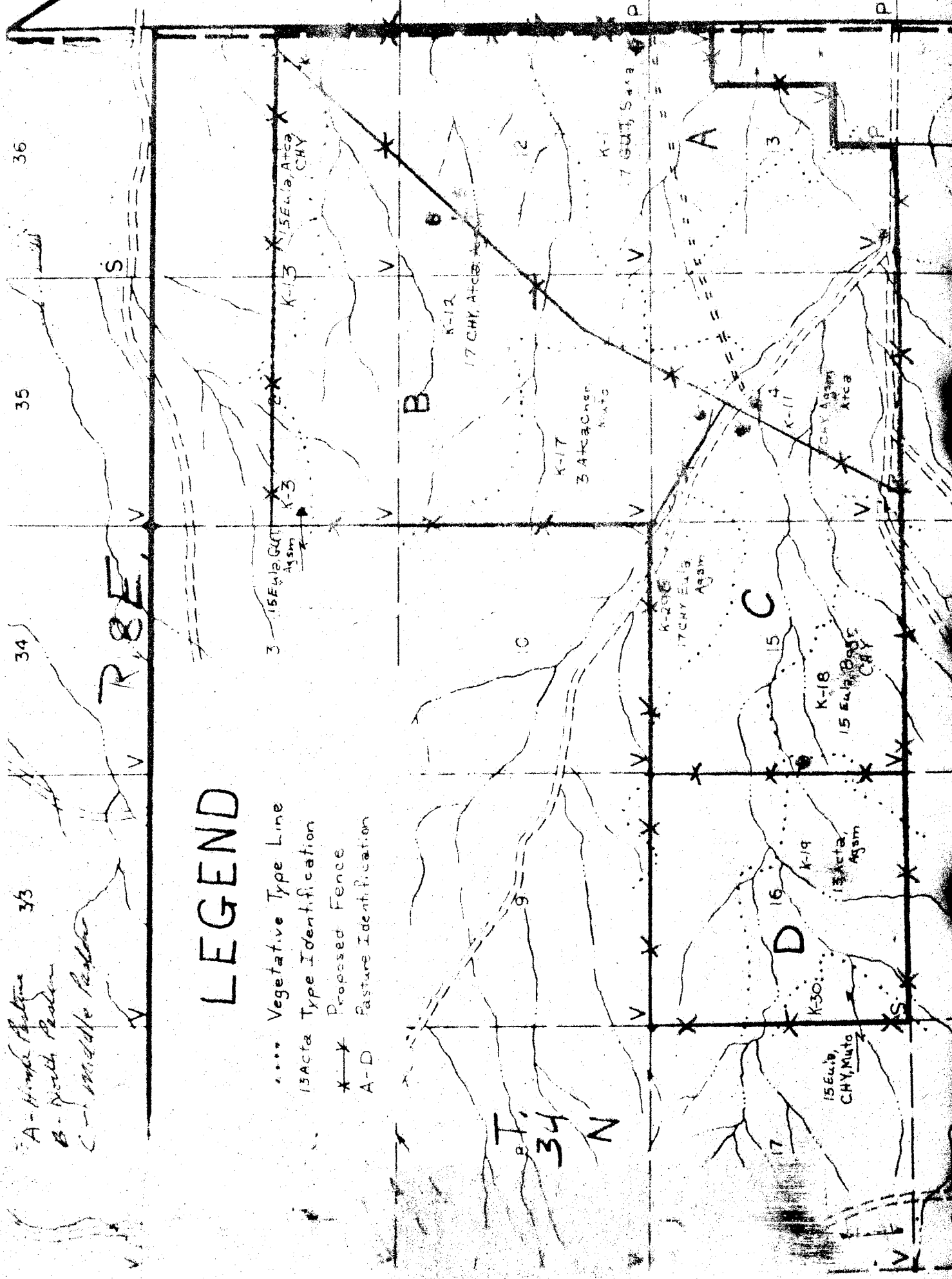

- A - Home Pasture
- B - North Pasture
- C - Middle Pasture

LEGEND

- Vegetative Type Line
- 13 Acta Type Identification
- X Proposed Fence
- A-D Pasture Identification

34
N

15 Eula, GUY
CHY, Muto

K-19
13 Acta, Agsm

K-20
17 CHY, Eula, Agsm

K-18
15 Eula, GUY

K-17
3 AKachen

K-12
17 CHY, Atca

K-3
15 Eula, GUY
Agsm

K-13
15 Eula, Atca
CHY

36

35

34

33

R 8 E

S

V

V

V

V

V

V

V

V

V

V

V

V

V

V

V

V

V

V

V

P

P

P

P

P

P

P

TABLE 2
SEQUENCE OF TREATMENT

Pasture	A	B	C	D
1	GL	RS	RV	RR
2	RV	RR	RS	GL
3	RS	GL	RR	RV
4	RR	RV	GL	RS
5	GL	RS	RV	RR
6	RV	RR	RS	GL
7	RS	GL	RR	RV
8	RR	RV	GL	RS
9	GL	RS	RV	RR

Y
E
A
R

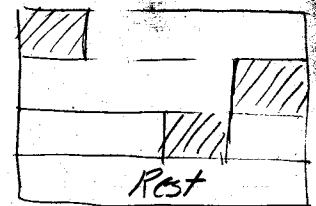

GL - Spring Season
RV - Winter Season

RS - Fall Season
RR - Total Rest

Key Species for Vegetative Types

<u>Type</u>	<u>Key Species</u>
17 GUT, Saka (K-1)	Eula, Agsm
15 Eula, GUT, Agsm (K-3)	Eula, Atca, Agsm, Orhy
17 Chgr, Agsm, Atca (K-11)	Eula, Atca, Agsm
17 CHY, Atca, Agsm (K-12)	Eula, Atca, Agsm
15 Eula, Atca, CHY (K-13)	Eula, Atca, Agsm
13 Atca, Chgr, Muto (K-17)	Eula, Atca, Agsm
15 Eula, Bogr, CHY (K-18)	Eula, Atca, Agsm
13 Atca, Agsm (K-19)	Atca, Agsm
17 CHY, Eula, Agsm (K-29)	Eula, Atca, Agsm
15 Eula, CHY, Muto (k-30)	Eula, Atca, Agsm

5/16/65

TABLE 3

Management Plan
 Uvaldo & E. D. Cisneros
 Mogote Unit
 250 Sheep
 1966

Pasture	No. Animals	AUM Capacity	Permitted AUM		Season	Total Days
			Licensed	Actual		
A	250	71	37	52	5/16 to 6/15	31
	250	--	37	50	11/16 to 12/15	30
B	250	53	37	52	10/1 to 10/31	31
	250	--	19	27	12/16 to 12/31	16
C	250	68	64	89	1/1 to 2/22	53
D	250	71	-- REST	--		
Totals		<u>263</u>	<u>194</u>	<u>270</u>		<u>161</u>
Less		<u>71</u>				
		<u>192</u>				

Summary of application & license - 1966

250 sheep	5/16 to 6/15	73% F. R.	37 AUMs
250 sheep	10/1 to 10/31	73% F. R.	37 AUMs
250 sheep	11/16 to 2/22	73% F. R.	<u>119 AUMs</u>
			<u>193</u>

5/16/65

TABLE 3(A)

Management Plan
Uvaldo & E. D. Cisneros
Mogote Unit
250 Sheep
1967

Pasture	No. Animals	AUM Capacity	Permitted AUM		Season	Total Days
			Licensed	Actual		
D	250	71	37	52	5/16 to 6/15	31
	250	--	29	59	11/16 to 12/8	23
C	250	68	37	52	10/1 to 10/31	31
	250	--	29	39	12/9 to 12/31	23
A	250	71	64	89	1/1 to 2/22	53
B	250	53	-- REST ---			
Totals		<u>263</u>	<u>196</u>	<u>271</u>		<u>161</u>
Less		<u>53</u>				
		210				

Summary of application & license - 1967

250 sheep	5/16 to 6/15	73% F. R.	37 AUMs
250 sheep	10/ 1 to 10/31	73% F. R.	37 AUMs
250 sheep	11/16 to 12/15	73% F. R.	37 AUMs
250 sheep	12/16 to 2/22	73% F. R.	82 AUMs
			<u>193</u>

TABLE 3(E)

Management Plan
Uvaldo & E. D. Cisneros
Mogote Unit
250 Sheep
1968

<u>Pasture</u>	<u>No. Animals</u>	<u>AUM Capacity</u>	<u>Permitted / AUM</u>		<u>Season</u>	<u>Total Days</u>
			<u>Licensed</u>	<u>Actual</u>		
B	250	53	37	52	5/16 to 6/15	31
	250	--	19	25	11/16 to 11/30	15
A	250	71	37	52	10/1 to 10/31	31
	250	--	37	52	12/1 to 12/31	31
D	250	71	64	89	1/1 to 2/22	53
C	250	68	-- REST ---			
	<u>Totals</u>	<u>263</u>	<u>194</u>	<u>270</u>		<u>161</u>
	<u>Less</u>	<u>68</u>				
		<u>195</u>				

Summary of application & license - 1968

250 sheep	5/16 to 6/15	73% F. R.	37 AUMs
250 sheep	10/ 1 to 10/31	73% F. R.	37 AUMs
250 sheep	11/16 to 12/31	73% F. R.	55 AUMs
250 sheep	1/ 1 to 2/22	73% F. R.	64 AUMs
			<u>193</u>

5/16/65

TABLE 3(C)

Management Plan
Uvaldo & E. D. Cisneros
Mogote Unit
250 Sheep
1969

<u>Pasture</u>	<u>No. Animals</u>	<u>AUM Capacity</u>	<u>Permitted AUM</u>		<u>Season</u>	<u>Total Days</u>
			<u>Licensed</u>	<u>Actual</u>		
C	250	68	37	52	5/16 to 6/15	31
	250	--	31	42	11/16 to 12/10	25
D	250	71	37	52	10/1 to 10/31	31
	250	--	33	44	12/11 to 1/5	26
B	250	53	58	81	1/6 to 2/22	48
A	250	71	-- REST	--		
<u>Totals</u>		<u>263</u>	<u>196</u>	<u>271</u>		<u>161</u>
<u>Less</u>		<u>71</u>				
		<u>192</u>				

Summary of application & license - 1969

250 sheep	5/16 to 6/15	73% F.R.	37 AUMs
250 sheep	10/ 1 to 10/31	73% F.R.	37 AUMs
250 sheep	11/16 to 12/10	73% F.R.	31 AUMs
250 sheep	12/11 to 1/5	73% F.R.	33 AUMs
250 sheep	1/6 to 2/22	73% F.R.	58 AUMs
			<u>196</u>