

**Mad Lake Experimental Planting Area**  
**Planted - October 25, 1946**  
**Maggy Camp District - Hodge National Forest**

This experimental planting area is located in the southeast corner of the administrative planting area. Drill plots are 12 feet wide by 300 feet long. Series I has twelve plots and Series II has eleven plots. Two plots were left unplanted in Series I and three plots were left unplanted in Series II. There was not sufficient seed of Plot No. 12 to include it in Series II. The plots are as follows:

Plot No.	OR No.	Scientific Name	Common Name	Source	Rate per acre
1	103	<i>Bromus inermis</i>	Smooth brome	Commercial	20
2	10	<i>Agropyron smithii</i>	Western wheatgrass	Kansas	20
3	105	"	"	Oregon	20
4	106	" <i>paniculatum</i>	Slender "	Commercial	15
5	104	" <i>crispatum</i>	Crested "	"	15
6	119	<i>Hymenocloa glauca</i>	Blue wildrye	P-10120, Pleasanton, Calif., SCS	10
7	54	<i>Phalaris arundinacea</i>	Reed's canary grass	Commercial	10
8	109	<i>Phleum pratense</i>	Timothy	"	15
9	54	<i>Koeleria cristata</i>	Chewings fescue	"	15
10	81	<i>Festuca idahoensis</i>	Idaho fescue	Lassen N. P.	10
11	100	<i>Sesale cereale</i>	Cereal rye	Commercial	60
12	67	<i>Agropyron cristatum</i>	Crested rhyzomatous wheatgrass	Albuquerque N.M., SCS	10

The grass plots are crossed by a strip of ladak alfalfa 3 drills or 12 feet wide by 312 feet long at the rate of 20 pounds of seed per acre.

A rectangular area was drilled on the east side of the plots, 300 feet by 120 feet. Mad Lake mixture was planted at the rate of 20 pounds per acre. This area was divided into two triangular areas on the basis of treatment ahead of drilling as shown in sketch. The triangle bordering Series I and Series II drilled plots was one-way disc plowed by the Hodge Forest Administrative crew as all of

the other seeding area was treated. The second triangular area on the east was untreated. Seed was drilled into the standing sagebrush with the plan of conducting some mowing experiments in 1947.

A small rectangular area was drilled to Mid Lake mixture as prepared by the Modoc Forest. This area, 90 feet by 300, is along the west end of Series I and Series II drilled plots, see sketch. Part of it had received considerable packing by tractor and drill in traveling from Series I plots to Series II plots, ahead of the actual drilling of this rectangular area.

Mid Lake mixture was made as follows:

Crested wheatgrass	-	1/2	parts	by	weight
Smooth bromegrass	-	1/2	"	"	"
Western wheatgrass	-	1/2	"	"	"
Ladak alfalfa	-	1	"	"	"

Single-row plots are southwest of Series I, see sketch. The rows are each 20 feet long, spaced 19.5 inches apart, and planted in triplicate, in Series I, II, and III as shown in sketch of Mid Lake Row plots. The twenty-five species or strains are as follows:

Plot No.	GR No.	Scientific Name	Common Name	Source
1	60	<i>Agropyron smithii</i>	Western wheatgrass	Commercial
2	62	" <i>crispatum</i>	Crested "	"
3	90	<i>Agrostis alba</i>	Red top	"
4	68	<i>Bromus inermis</i>	Smooth bromegrass	"
5	54	<i>Dactylis glomerata</i>	Orchard grass	"
6	88	<i>Elymus glaucus</i>	Blue wildrye	Lassen N. P.
7	81	<i>Festuca idahoensis</i>	Idaho Fescue	" " "
8	64	<i>Festuca rubra commutata</i>	Chewings fescue	Commercial
9	66	<i>Trifolium hybridum</i>	Alsike clover	"
10	63	<i>Medicago sativa x falcata</i>	Ladak alfalfa	"
11	61	<i>Trifolium repens latum</i>	Ladino-alsike	"
		<i>Trifolium hybridum</i>		
12	82	<i>Poa nevadensis</i>	Nevada bluegrass	Lassen N. P.
13	89	<i>Purshia tridentata</i>	Bitterbrush	SCS, P-9070
14	90	"	"	Lassen, N. P.
15	62	<i>Agropyron crispatum</i>	Crested wheatgrass	SCS, Standard

No.	SI No.	Scientific Name	Common Name	Source
14	54	<i>Phalaris arundinacea</i>	Reed's canary grass	Commercial
17	59	<i>Phleum pratense</i>	Timothy	"
18	55	<i>Poa annua</i>	Big bluegrass	SCS, P-5716
19	56	<i>Agropyron trachycaulum</i>	Slender wheatgrass	Commercial
20	57	" <i>anthii</i>	Western "	SCS, P-5573
21	16	<i>Agrostis alba tenuis</i>	Asteria bent	Commercial
22	29	<i>Pectylois glomerata</i>	Orchard grass	SCS, P-3199
23	64	<i>Phalaris arundinacea</i>	Reed's canary grass	SCS, P-559
24	53	<i>Lolium perenne</i>	Perennial ryegrass	S.J.-745
25	52	<i>Pennisetum ciliatior</i>	Tall fescue	S.J.-734

# Mud Lake - Modoc

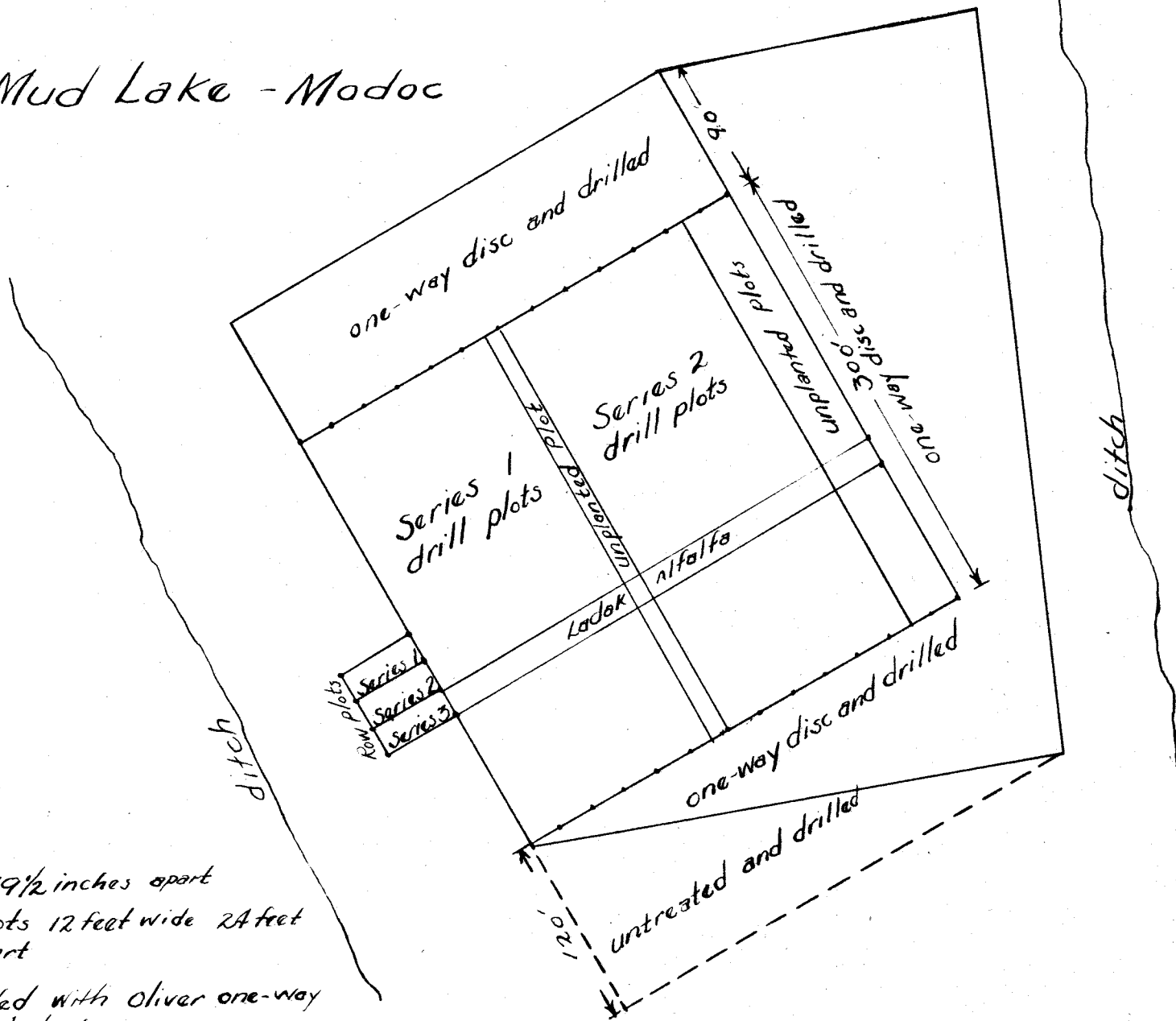

Rows 19 1/2 inches apart  
 Drill plots 12 feet wide 24 feet  
 apart

Area tilled with Oliver one-way  
 wheatland plow

plots drilled with 6 foot Van Brunt  
 grain drill; 2 rails and "Cat drawbar"  
 dragged in front of drill as leveler.

# Mud Lake Row Plots

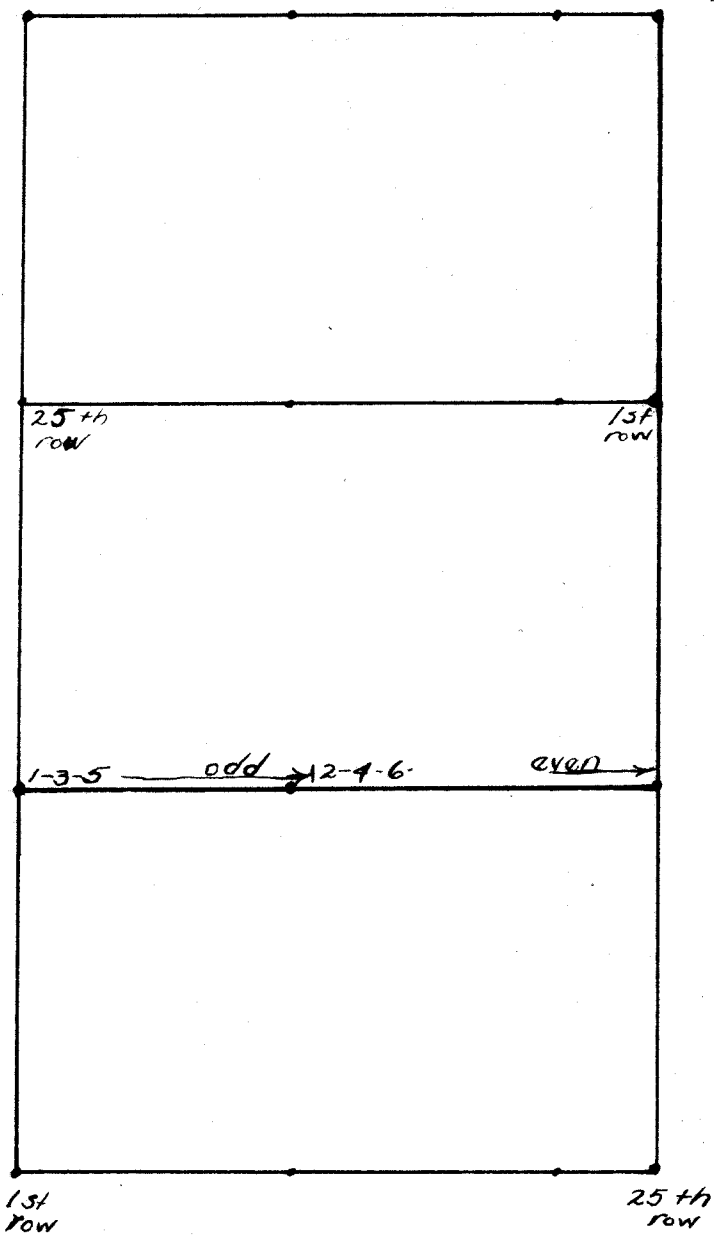

25 rows replicated three times