

RESULTS OF RODENT TRAPPING

B.S.E.R. 1936

Date

December 19, 20, & 21, 1936.

Purpose of trapping

To obtain a rough estimate of the number and species of rodents active on the B.S.E.R. that would be likely to eat or remove pine seeds being sown at this time.

Area

Location - N half Pasture I, Burgess Spring Experimental Range,

Lassen N.F., Sec. 18 & 19, T 33 N, R 8 E, MDM

Elevation - 6000'

Type - Cutover Ponderosa - Jeffrey Pine

Acreage - 300 (approximate)

Method

Traps

106-108 common mouse traps baited with bread

Placement

Set under limbs and logs on the soil or litter. None set directly on snow. Spaced at an average of 15 yards apart on a line.

Distribution

The traps were moved each of the 3 nights. For distribution see map.

Catch

Date	12/19/36	12/20/36	12/21/36
Location	West side	Center	East side
Traps set	108	106	106
Peromyscus	4	4	9
Microtus	3	1	4
Traps sprung	3	1	0
Traps lost	2	0	0

Weather

Burgess Spring Experimental Range Sec. 18, T 33 N, R 8 E, MDM

Date	Temperature		Precipitation
	Max.	Min.	
Dec. 19	44	28	none
Dec. 20	44	32	T
Dec. 21	46	32	none
		32	

Blacks Mt. Branch Sta. Sec. 13, T 33 N, R 6 E, MDM

Date	Temperature		Precipitation
	Max.	Min.	
Dec. 9	36.8	14.7	none
10	49.4	16.9	none
11	53.4	9.6	none
12	-	-	-
13	58.7	18.5	none
14	50.3	25.2	none
15	37.4	27.8	.08
16	36.0	12.7	.10
17	42.9	7.8	T
18	51.3	10.8	none
19	47.1	12.6	none
20	45.9	23.0	none
21		27.7	none

On the first day of trappine, Dec. 19, 2 $\frac{1}{2}$ " of snow covered the ground. This melted rapidly until about 30% was left Dec. 21. The soil was moist to a depth of about 2" and below this the moisture content was at the wilting point.

R9E

TRAP LINES

B. S. E. R. 1936

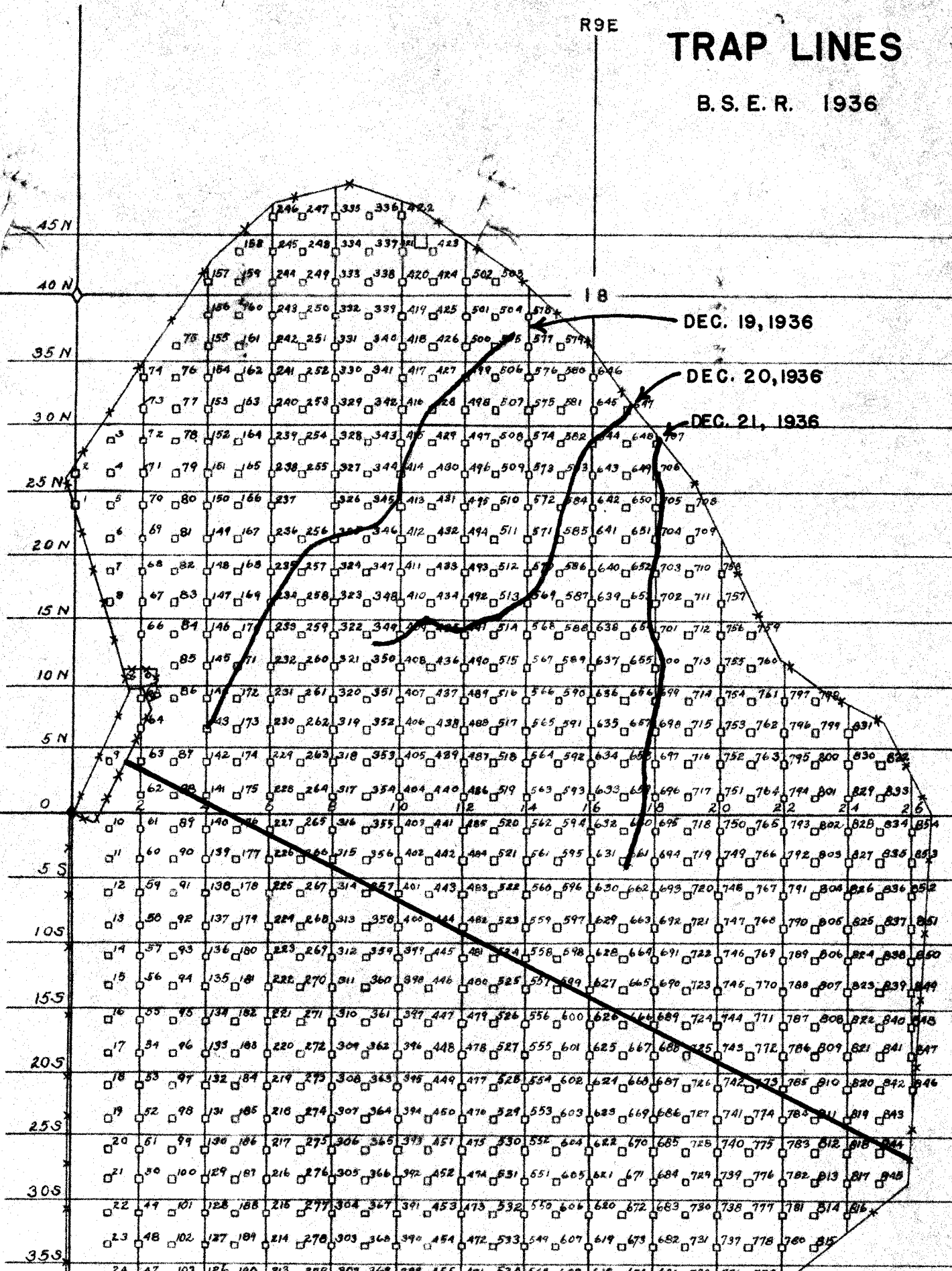

Table No. Lack of rodent activity in early winter,
Burgess Spring Experimental Range, 1936.

Date (1936)	Location in pasture	Results					Total traps set
		Catch		Other traps			
		Peromyscus	Microtus	Lost	Sprung	Not Sprung	
		<u>Number</u>	<u>Number</u>	<u>Number</u>	<u>Number</u>	<u>Number</u>	<u>Number</u>
Dec. 19	West side	4	3	2	3	96	108
Dec. 20	Center	4	1	0	1	100	106
Dec. 21	East side	9	4	0	0	93	106
	Total	17	8	2	4	289	320