

Hi Gus :

MAY 16, 1985

I hope this information finds you well. This information contains some articles I thought you might like. Also there is an allotment map for "Big Flat - Ten Mile Allotment" and the "Taylor Allotment", the two allotments we visited.

Give me a call if you have some questions or can help.

Respectfully yours,

Don Wilbur

**Montana Department of
Fish, Wildlife & Parks**

RECEIVED
MAY 21 1985
WILDLIFE DIVISION

Office Memorandum

TO : Arnie Olsen
FROM : Don Hyypa *Don*
SUBJECT: Grazing Plan for Aunt Molly FAS

DATE: May 20, 1985

I really appreciate the work that Joe Egan and Gus Hormay have done on this grazing plan. I hope that we are able to get cooperation from the Taylors to implement it so that we can begin to properly manage this property.

It appears that the ground work has been properly laid for the Region to work with the Taylors to adopt the program this spring. Via copy of this memo to Jim Ford, I am asking that he follow up on this matter and notify us if he runs into any problems in this regard.

Thanks again.

b

cc: ~~Joe Egan~~
Jim Ford
Tom Greenwood/enclosure
Don Malmberg/enclosure
Don Malisani

AUGUST L. HORMAY
RANGE MANAGEMENT CONSULTANT

101 ACADIA STREET • SAN FRANCISCO, CALIFORNIA 94131

May 25, 1985

Nr. Morgan S. Jensen, District Manager
Bureau of Land Management
Cedar City District Office
Cedar City, Utah 84720

Dear Morgan,

I spent a rewarding day on the Cook Allotment last May 3rd. Your men can be proud of their accomplishments with rest-rotation grazing there.

Mrs. Rosalie Cook and her foreman Hampton Burke spent the day with us. Rosalie attended a rest-rotation grazing session of mine in Kanab several years ago. The good results on the allotment can be attributed in a large measure to her. She followed the grazing formula religiously and applied rest-rotation grazing principles with insight.

The present grazing plan (formula) is a good one but can be improved for better results and a simpler operation.

Both herbaceous plants and shrubs, especially the latter, need more rest for maximum vigor and production.

Both need heavier grazing. In the case of herbs (grasses and forbs) heavy use promotes greater stooling, rhizome extension and regrowth. In shrubs it stimulates adventitious growth.

The present plan does not provide for leaving old growth in the pasture that is grazed first in spring. This growth is needed to supply roughage to go along with new succulent growth. Also, it increases the grazing capacity of the pasture.

With the present plan cattle are moved from one pasture to another twice during the summer grazing season. They are moved across intervening pastures, two years out of four. This amount of handling can be reduced.

The present plan can be improved greatly by replacing treatment D with a year-long rest treatment, the same as treatment C. I have designated this second year-long rest treatment C'.

With the substitution--

1. Sufficient additional rest is provided to maintain both herbs and shrubs in full vigor.
2. Two pastures instead of three are grazed. So forage use is increased and spread more widely in the pastures. This is desirable.
3. Stock handling is reduced and simplified. The cattle are moved between pastures but once a season. In 3 years out of 4 they move to adjoining pastures. In only one year do they move across intervening pastures.

This new plan is shown along with the present one on attached page 1. I would like to see you try it yet this year. There would be little change in the grazing operation. The same pastures would be grazed and in the same order as under the present plan. Only the time of moving cattle would be changed.

The pasture layout on the allotment is shown on attached page 2. I numbered the pastures for easy identification.

The grazing schedule for the next four years is shown on attached page 3.

If you decide to go with the plan proceed as follows:

1. Hold the cattle in pasture 1 (they are there now) as long as they make normal weight gains.
2. If there is not enough capacity in the pasture to carry the cattle until seed-ripe time, open pasture 2 to use as soon as the cattle show slightest signs of being pressed for feed.
3. Let the cattle graze in pastures 1 and 2 with gates between them open through to the end of the season.
4. If there is not enough capacity in these pastures until then, open pasture 3 to use.

Don't worry about degree of forage use in the pastures. The range will improve with the heaviest use that can be made of the vegetation. There is capacity as long as the cattle do well.

Looking ahead to the next grazing season, put the new steers that will start coming onto the allotment this fall into pasture 3. Graze in this one pasture until the start of the summer grazing season. If there is not enough grazing capacity in it to do this, open pasture 2 to use.

Do not graze in pasture 4 if it can be avoided. It will be grazed first in spring.

Please call me in San Francisco at 415-587-3155 if you have questions. Good Luck,

Sincerely,

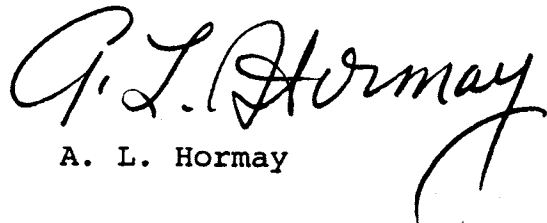
A handwritten signature in cursive script that reads "A. L. Hormay". The signature is written in black ink and is positioned above the printed name.

A. L. Hormay

be/ALH

Attachment

Cook Allotment
Cedar City District BLM

Proposed Grazing Plan

Pasture

Grazing treatments ✓

1												
2	B											
3	C											
4	C'											
	Apr	May	Jun	July	Aug.	Sept	Oct	Nov	Dec	Jan	Feb	Mar

Present Grazing Plan

Pasture

Grazing treatments ✓

1												
2	B											
3	C											
4	D											
	Apr	May	Jun	July	Aug	Sept	Oct	Nov	Dec	Jan	Feb	Mar

✓ As applied in pastures during The 1985-86
grazing season

A. Hormay
May 22, 1985

Attachment
Cook Allotment

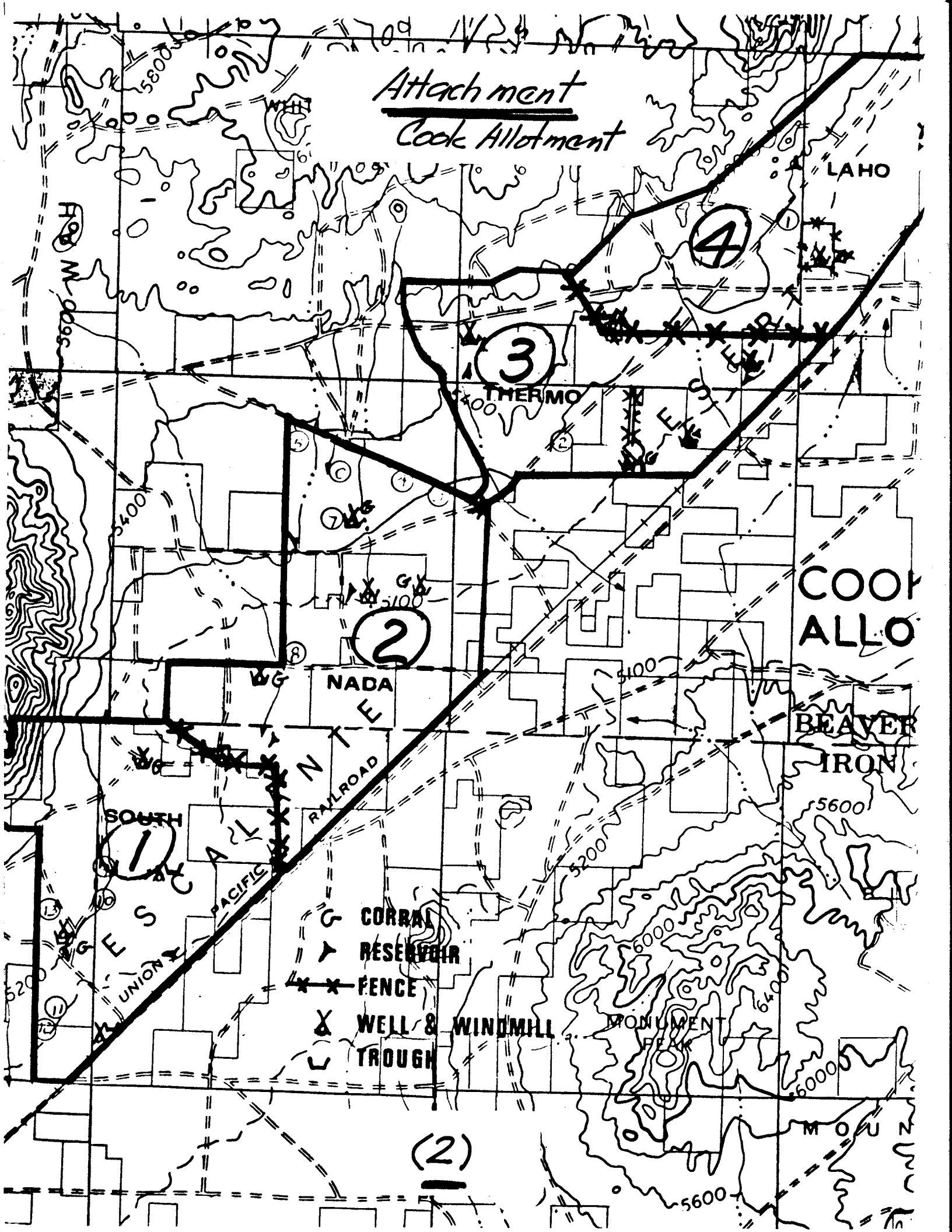

Attachment

COOK ALLOTMENT
CEDER CITY DISTRICT, BLM.

PASTURE GRAZING SCHEDULE
FOR
PROPOSED GRAZING PLAN

SEASON :	PASTURE			
	1 SOUTH	2 NADA	3 THERMO	4 LAHO
	GRAZING TREATMENT			
1985-86	A	B	C	C'
1986-87	B	C	C'	A
1987-88	C	C'	A	B
1988-89	C'	A	B	C

**Montana Department of
Fish, Wildlife & Parks**

Office Memorandum

TO : Joe Egan
FROM : John Firebaugh ^{A7} and Lyn Nielsen
SUBJECT: Grazing Plan for Aunt Molly FAS

DATE: 5/28/85

Lyn and I have reviewed Hormay's proposed grazing plan for this area and we have several concerns and comments.

Hormay has set up a 3 pasture system for summer grazing and explained to Mr. Taylor the extreme importance of resting a portion of the system annually. However, that isn't how the system is set up. On page 3 Hormay states: "There is not enough capacity in pastures 1 and 2 to carry the cattle through to the end of the season, so pasture 3 (the suggested rest pasture) will have to be grazed." If the system is to work, there has to be rest incorporated into it.

He also suggested for pastures 1 and 2 that the cattle graze these areas until "the cattle show signs of being short of feed," then the gates are opened so they can use adjoining pastures as well. This system appears to be set up mainly for the needs of the cattle and not for wildlife or vegetation. There's no mention of grazing until seed-ripe time or resting until seed-ripe time then grazing. He proposes just grazing the areas until "the cattle show signs of being short of feed."

Another problem is the short capacity of pasture 3 (FWP lands) which he proposes to solve by moving the cattle to the winter pastures (11, 12 and 19) also FWP lands. On these and other pastures, residual cover is important for nesting waterfowl as well as wintering turkeys and white-tailed deer along the river bottom. If resting does occur under treatment C, it would be vital to retain this residual growth through the next spring nesting season and not use it up immediately as roughage for cattle. In addition, the winter pastures will need to be rotated to provide for wildlife food and cover and river bank enhancement.

JF/pm

STATE OF MONTANA



**DEPARTMENT OF
FISH AND GAME**

Helena, MT 59620
May 30, 1985

Mr. Gus Hormay
101 Acadia
San Francisco, CA 94131

Dear Gus:

Here are copies of responses to your grazing plan
at Aunt Molly FAS (Taylor Ranch).

Regards,

Joseph L. Egan
Joseph L. Egan, Chief
Management Bureau

JLE:kc

Enc.

Montana Department of Fish, Wildlife & Parks

Office Memorandum

TO : John Firebaugh

DATE: May 30, 1985

FROM : Joe Egan

SUBJECT: AUNT MOLLY REST-ROTATION

In your May 28, 1985 letter you point out some "shortcomings" of Hormay's suggested grazing plan for Aunt Molly FAS.

Hormay can only suggest and/or recommend. The department is the outfit that says what's to be done.

Note the plan calls for fence. Is the fence being installed? The plan indicates the first year or two will help to determine grazing capacities. The plan indicates insufficient grazing capacities in some pastures. What action is the department taking to take care of that problem.

There are and have been obvious problems with past livestock use on the FAS. Is the current proposal worse than the "plan" in effect in the past?

I think Hormay needs another day or two on the FAS. Is there any money for such a trip?

JLE:kc

cc: ✓G. Hormay