

San Francisco, Ca.

April 25, 1985

Mr. Don Taylor
TBM Ranch
Helmville, MT. 59843
Phone: (406) 793-5625

Dear Don and Patty,

I hope you are in good health and eager to take on another year.

I want to get this letter to you before you turn the cattle out this spring because I have a suggestion on how you can get started with rest-rotation grazing yet this year.

No, I have not completed the grazing plan yet. I have to see more of the range and have further discussions with you. Furthermore if the plan is to be practical and satisfactory to both you and the Department we will have to work it out together. I am clear on the kinds of rest-rotation grazing systems needed but not on how they can be best fitted into your operation.

The grazing plan will apply on all Fish and Game lands, except for a few small recreation areas, and on TBM Ranch lands not used in conjunction with the Savery grazing system.

First a word about rest-rotation grazing, so you can better understand my suggestion. The Fish and Game Department, as you know, is interested only in a kind of grazing that will improve and maintain the vegetation in its most productive condition for benefit to wildlife and enhancement of recreation, esthetic and other renewable resource values. I'm sure you too are interested in such improvement for it means greater livestock grazing capacity. There is substantial room for improvement on much of the ranch.

Vegetation can improve only when it is rested from use. Maximum improvement can be obtained with periodic resting that is geared to satisfy the growth requirements of the plant. During rest periods plants are provided opportunity to recover vigor and production capacity and seedlings have opportunity to establish.

Files

2 copies Joe Egan

In rest-rotation grazing the duration and timing of grazing and resting are objectively determined for each range on the basis of kind of vegetation and season of grazing. Thus, different grazing systems are developed for ranges differing in kind of vegetation or season of use.

In the present case two grazing systems are needed, a 3-pasture system for summer range and a 2-pasture system for winter range. Plans for use of the latter will be developed this summer.

In the 3-pasture system two pastures are grazed and one rested each year. One pasture is grazed from the beginning of the grazing season until seed of the principal forage grass ripens. A second pasture is rested from use until seed-ripe time and then grazed there after to the end of the season. The third pasture is rested year long.

The beginning of the season is marked by the time the vegetation starts growing rapidly - in spring, probably around May 15 in the present case and seed-ripe is probably reached around August 1. I arbitrarily set the end of the grazing season at October 1.

In a normal grazing operation all the cattle are put into one pasture say number 1 at the begining of the season and kept there until seed-ripe time. Then they are moved to a second pasture - number 2 and allowed to graze there to the end of the season. Pasture 3 is rested.

Different pastures are grazed and rested each year as shown in the following grazing schedule:

GRAZING SCHEDULE

YEAR	PASTURE		
	I	2	3
	Grazing treatment		
1. (1985)	A	B	C
2.	B	C	A
3.	C	A	B
4.	A	B	C
5.	B	C	A
6.	C	A	B

Here grazing treatment A stands for grazing from the beginning of the season until seed-ripe time, grazing treatment B for resting until seed-ripe and grazing thereafter, and grazing treatment C for year long resting.

The grazing treatments are applied in ABC order in each pasture over time indefinitely. Plants reach full vigor and an increment of reproduction is established, site and weather conditions permitting, at the end of each cycle of ABC treatments.

Growth left on the ground with resting under treatment C is not wasted. It is available for use the following spring under treatment A. At this time it provides much needed roughage to go along with the new lush green growth.

I suggest you try operating the 3-pasture system on the summer range used by the commercial herd. I blocked out an arrangement of pastures on the attached map.

To operate the system efficiently the pastures should have about the same grazing capacity. S fence is needed between areas (2) and (4) to balance the capacities of pastures 1 and 2. A temporary electric fence will serve for the time being. It should run east-west about 500 yards below the North boundary of the section.

Pasture 3 has only about 85% of the capacity of pastures 1 and 2, perhaps this difference can be obtained from areas (11) (12) or (19). The areas and grazing capacities of the three pastures are shown below:

PASTURE	ACRES	AUMs*
1	673	531
2	507	530
3	<u>453</u>	<u>453</u>
TOTAL	1633	1514

* Based on actual use

There is not enough capacity in pastures 1 and 2 to carry the cattle through to the end of the season, so pasture 3 will have to be grazed.

All this may sound complicated but proceed as follows:

1. Hold the cattle on winter feeding areas, (11), (12), (13), (14), (15) and (16) until forage starts growing rapidly May 15 ±. Then
2. Move the herd to area (1) in pasture 1. and graze there until the cattle show signs of being short of feed, then
3. Open gates into areas (2) and (3) and leave them open so the cattle can continue to graze in (1) as well as graze in (2) and (3).
4. When the cattle show signs of being short of feed open gates into unit (4) in pasture 2 and leave them open so the cattle can graze in (1) (2) (3) and (4).
5. When the cattle run short of food on these areas open gates into (5). After a few days round up all the cattle in (1) (2) (3) and (4) and put them in (5) and then into (6).
6. When the cattle run short of food in (6) move them South into pasture 3 -areas (16) (17) and (18), to finish the season.

By grazing this way you should pick-up some additional grazing capacity yet this year. Keep track of the number of animals and period of use in each pasture or fenced unit. This information is important in determining grazing capacities.

I plan to visit you later on, probably in July, to get on with further planning. I will get in touch about a definite date.

Please phone me if you have any questions before then.

Sincerely,



A. . "Gus" Hormay

be/ALH



2 copies Joe Egan

Map 1

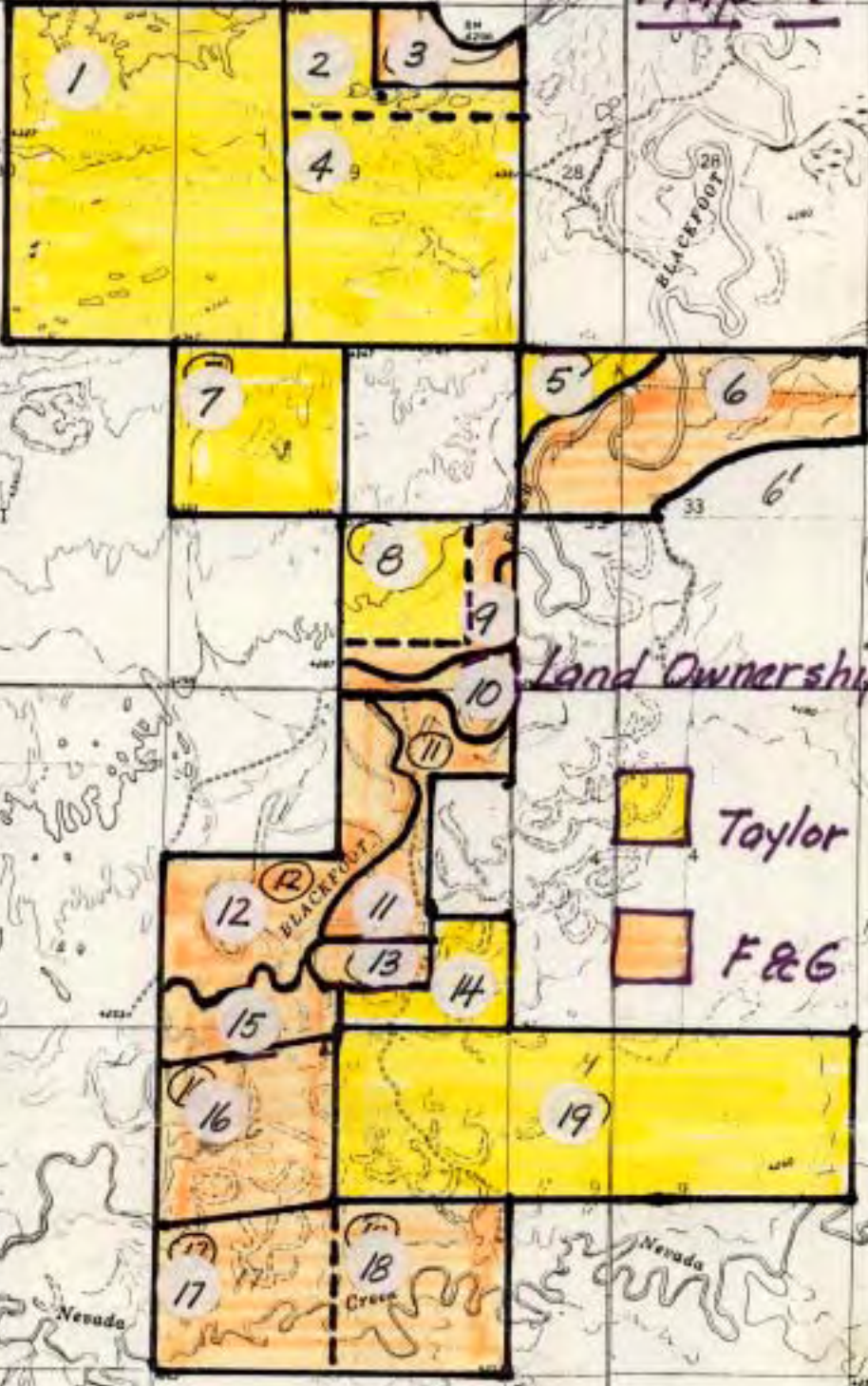
Map 1



Land Ownership

-  Taylor
-  F&G

Map 2

Map 2

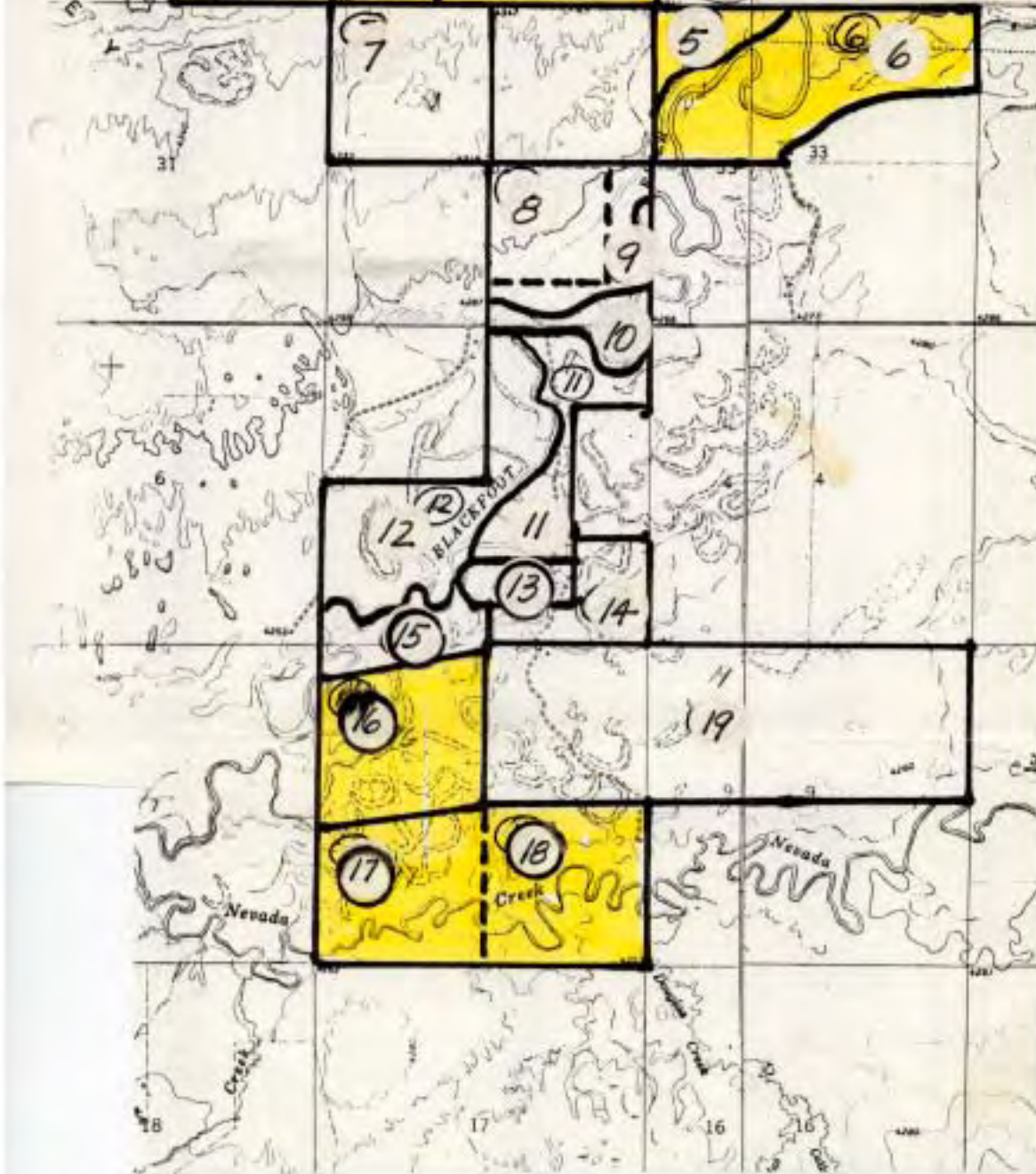

Map 3

Map 3

Pastures



Summer Pastures Commercial Herd

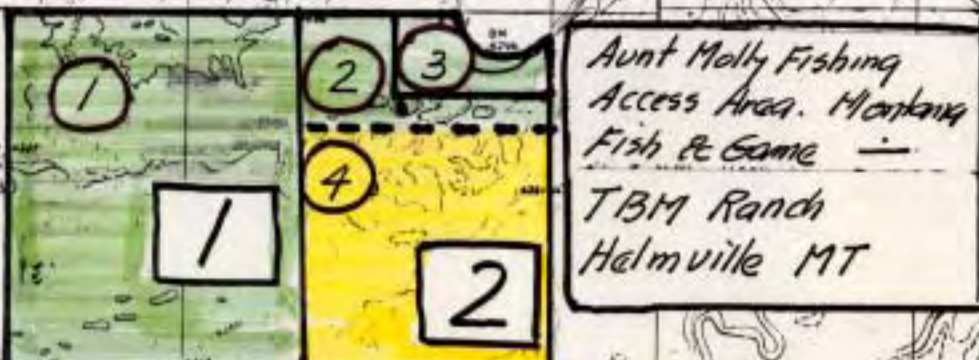

Legend



⑥ Area Number

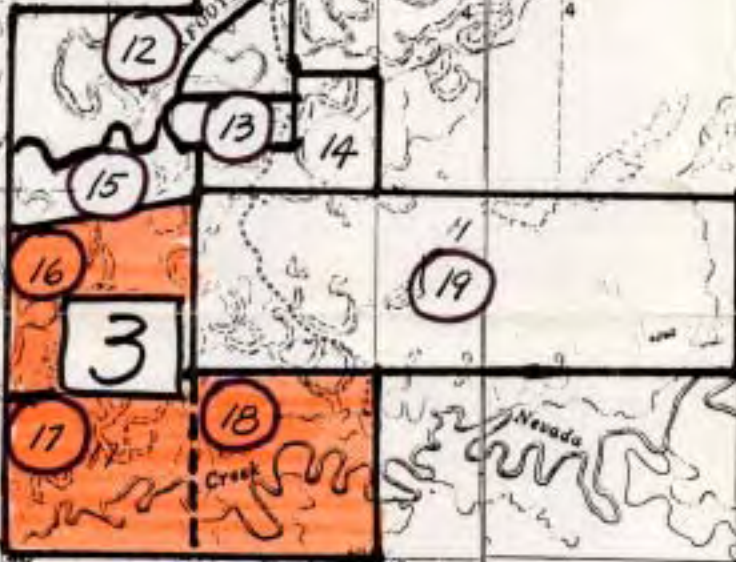

Hormay
April 24, 1985