

UNITED STATES GOVERNMENT

Memorandum

Reference: 1786

TO : State Director, Montana

DATE: April 2, 1975

FROM : District Manager, Billings

SUBJECT: Cooperative Agreement - Mystic-Pryor Spur Demonstration Area

Attached for your information is the recently completed Cooperative Agreement between the Billings District and Custer National Forest. This agreement provides for the implementation and demonstration of rest-rotation multiple-use land management on the Mystic-Pryor Spur Allotment which will be carried out under the guidance of Gus Hormay.

Gus has indicated that he is working on a format for preparation of rest-rotation plan and should have a first draft copy available to participating offices shortly. This guide will be used by a planning committee to complete a plan for the area.

Our original planning group numbered 45 and included personnel from the Forest Service, National Park Service, Montana Fish and Game Department, Sierra Club, Montana State University, Montana Wilderness Assoc., range users and Beartooth Conservation District. The planning committee will be nominated from this group and participate in the actual development of the demonstration area plan. Nominations will be sent to Gus as soon as we know how large the committee should be and their roles.

Target dates are FY 76 for plan completion and FY 77 for construction of facilities and implementation.

(Sgd.) C. Rex Cleary

Enclosure

Coop. Agreement--BLM-FS-Mystic Pryor Spur

cc: Al "Gus" Hormay ✓



5010-108

Buy U.S. Savings Bonds Regularly on the Payroll Savings Plan

COOPERATIVE AGREEMENT

B.L.M. Billings Dist.

BETWEEN

UNITED STATES FOREST SERVICE, U.S. DEPARTMENT OF AGRICULTURE

AND

BUREAU OF LAND MANAGEMENT, U.S. DEPARTMENT OF INTERIOR

I. PURPOSE

To provide procedures for planning, implementing, administering, and evaluating a Rest-Rotation, Multiple-Use Land Management Demonstration Area which includes both national resource lands and national forest lands. The Demonstration Area will be used to demonstrate how all renewable resources can benefit from rest rotation grazing management and how needed range improvements necessary for implementation can be located, designed and constructed with an absolute minimum of disruption to the environment.

The area involved will be the Mystic-Pryor Spur Allotment. The name is derived from a combination of the BLM Mystic Allotment and the FS Pryor Spur Allotment.

II. AUTHORITY

- A. Memorandum of Understanding dated November 8, 1966, between the United States Forest Service and Bureau of Land Management (FSM 2251.44) concerning interagency cooperation on matters related to range management.
- B. Pryor Mountain Complex Land Use Decisions dated May 23, 1974.

Related to the latter authority, the development of the Demonstration Area Plan may surface possibilities for modification to the land use decisions. Should modifications be deemed necessary, they will be reviewed by both agencies with due recognition to the broad citizen involvement that went into the decisions. Changes should not be taken lightly; yet they may be in order should new information surface that had not been duly considered in the decision-making process.

III. DEFINITIONS

- A. U.S. Forest Service means Forest Supervisor, Custer N.F., Billings, Montana.
 - 1. Field Contact - District Ranger, Beartooth District, Red Lodge, Montana.
- B. Bureau of Land Management means District Manager, Billings District, Billings, Montana.
 - 1. Field Contact - Area Manager, Apsuroka Resource Area, Billings, Montana.

IV. PROCEDURE

It is mutually agreed by and between the parties hereto as follows:

- A. To establish the Demonstration Area to supply information needed about livestock grazing and its ecological relationships to all renewable resources on subalpine ranges. In addition, particular emphasis will be given to planning and constructing facilities needed for implementation which give full consideration to the environment.
- B. To obtain this information, a joint management plan for the Mystic and Pryor Spur Allotments will be developed and necessary range improvement facilities constructed. Livestock will be managed under a grazing system utilizing the principles of rest rotation management. The duration of this study will be for two complete cycles of the grazing system. This can be from 6 to 8 years depending upon the grazing formula applied.
- C. This agreement recognizes the need for continuing with public involvement in the planning and evaluation process for this allotment. Special emphasis will be given to involving those individuals and organizations who participated in the initial Gus Hormay Demonstration Area training program for the Mystic-Pryor Spur Allotment in October, 1974.
- D. Close coordination will be maintained with Gus Hormay in development, review, and evaluation of the Demonstration Area.
- E. The Forest Service will make the Pryor Spur Allotment available for use by the domestic livestock, in the numbers and season, presently authorized by the Bureau of Land Management on the Mystic Allotment. The Forest Service agrees to allow this use on the Pryor Spur Allotment for two complete grazing cycles, or longer if the duration of this study is extended. If and when it is determined that there is grazing capacity available for allocation, it must be allotted in accordance with the procedures outlined in FSM 2232.4.
- F. The Bureau of Land Management will assume the lead responsibility for all the grazing administration within the study area. This includes but is not limited to authorizing the grazing use and the billing and collection of grazing fees.
- G. Studies for monitoring the effects of the grazing system and the ecological relationships will be conducted jointly by both agencies and data evaluated at least annually.

The type of studies necessary will be determined in the management plan.

- H. Supervision of the grazing use within the Mystic-Pryor Spur area will be conducted jointly by the Bureau of Land Management and the Forest Service. It will include periodic allotment inspection to insure compliance with the grazing treatment formula.
- I. The BIM will assume lead responsibility for planning all necessary range improvements for the demonstration area. However, any development proposed on the National Forests will be approved by the Forest Service prior to construction. The Forest Service will finance all improvements on forest lands. BIM will finance all range improvements on national resource lands. Target dates for construction of all necessary projects to implement the plan will be FY 1977. All projects will be dependent upon the availability of funds and manpower.
- J. Special effort will be made to keep this demonstration area highly "visible" to the public. One means will be to construct and install joint agency signs which explain the program to visitors.

V. REVIEW, MODIFICATION AND TERMINATION

During the first two grazing cycles, this agreement will be jointly reviewed at any time at the request of either agency. At the end of the first two grazing cycles, the two agencies will jointly review the agreement and determine if it will continue, with or without modification, or be terminated.

C. Rex Cleary
Billings District Manager
Bureau of Land Management

DATE

12/13/74

Robert W. Miller
Forest Supervisor
Custer National Forest

DATE

1/31/75

April 22, 1975

Memorandum

**To: DM, Battle Mountain District
Office**

From: Range Conservationist

Subject: Mount Airy AMP

Sorry to delay replying to your memorandum of March 26, 1975 for such a long time I was deeply involved in developing a format for multiple-use land management plans. I am still not finished with the first rough draft but hope to have it out in a couple of weeks.

I think the Mount. Airy AMP falls short of the type of plan the Bureau needs for managing lands under its jurisdiction. An AMP should be a multiple-use plan and should be developed with the help of the many outside interests that are concerned with wildland management and the quality of the natural environment.

The Mount Airy plan is heavily livestock production oriented. Other uses and values are not given adequate consideration. This can hardly be done without outside participation in planning. Rest-rotation management principles and the rest-rotation grazing formula that has been developed for the allotment are not being applied properly.

I believe it best not to try to salvage the present plan but to start all over with another that deals with multiple-use management more pointedly and that is based on a sounder foundation developed cooperatively by concerned wildland interests. This suggestion may be discouraging to you, but with the wealth of information you now have on the allotment I believe you can develop a sound plan acceptable to all concerned within a year or two at the most.

cc: State Office, Nevada

ALHORMAY:ng

4-22[1975]
4-22B

Gus - Hi! --

Going thru Federal Records Center lists today I came across some notes of possible interest to you -- our sidewalk conversation of a few days ago:

	<u>Dispose when</u>
p. 4, 8-4-71 Extension Program FY1961 Harvey Valley programs	5 years
Accession No. 69-A-1023, 2-18-69 FRC Nos. 422981, 422982, 422983 Harvey Valley Evaluation	Permanent
Accession No. 64-A-423, 4-17-63 Pallet No. 39 IBM cards - Harvey Valley Condition	
Accession No. 59-A-712, 4-24-59 FRC Nos. 4738, 4739, 4740, 4741 Burgess Sprs. data, 1933-38	Permanent

The lists are on Std. Form 135-A. I saw the copies held by Mrs. Stafford in Rm. 262. A more complete list is undoubtedly held by Mrs. Morris in Rm. 209.

I think you'll want to check on the current meaning of "permanent". They've made changes in how long FRC will hold records.

Cheerio --

Clark



United States Department of the Interior

IN REPLY REFER TO

4112.15

BUREAU OF LAND MANAGEMENT

Lander Resource Area

P. O. Box 589

Lander, Wyoming 82520

April 29, 1975

Mr. August L. Hormay
P. O. Box 245
Berkeley, CA 94701

Dear Gus:

We have considered the various aspects involved in implementing the Hall Creek AMP, and decided on three pastures. The specifics of their utilization and/or rotation are pending receipt of your AMP format and trip to the resource area this spring. Project plans have been completed on the fences necessary to effect a three-pasture system, with the work projected as follows:

1. Allotment boundary fence completed FY '75.
2. Interior pasture fence completed FY '76.

Please notify us if you feel that the proposals are inadequate to meet your demands, or that their planning should be halted until such time as further meetings and planning sessions are held. Any delay in constructing the two fences at this time would delay implementation of the management plan until FY '77.

Enclosed is a map showing the location and projected completion dates of the two fences.

Sincerely,

Dale P. Brubaker
Area Manager



1 Enclosure
Map

cc w/encl.
WSO (932)

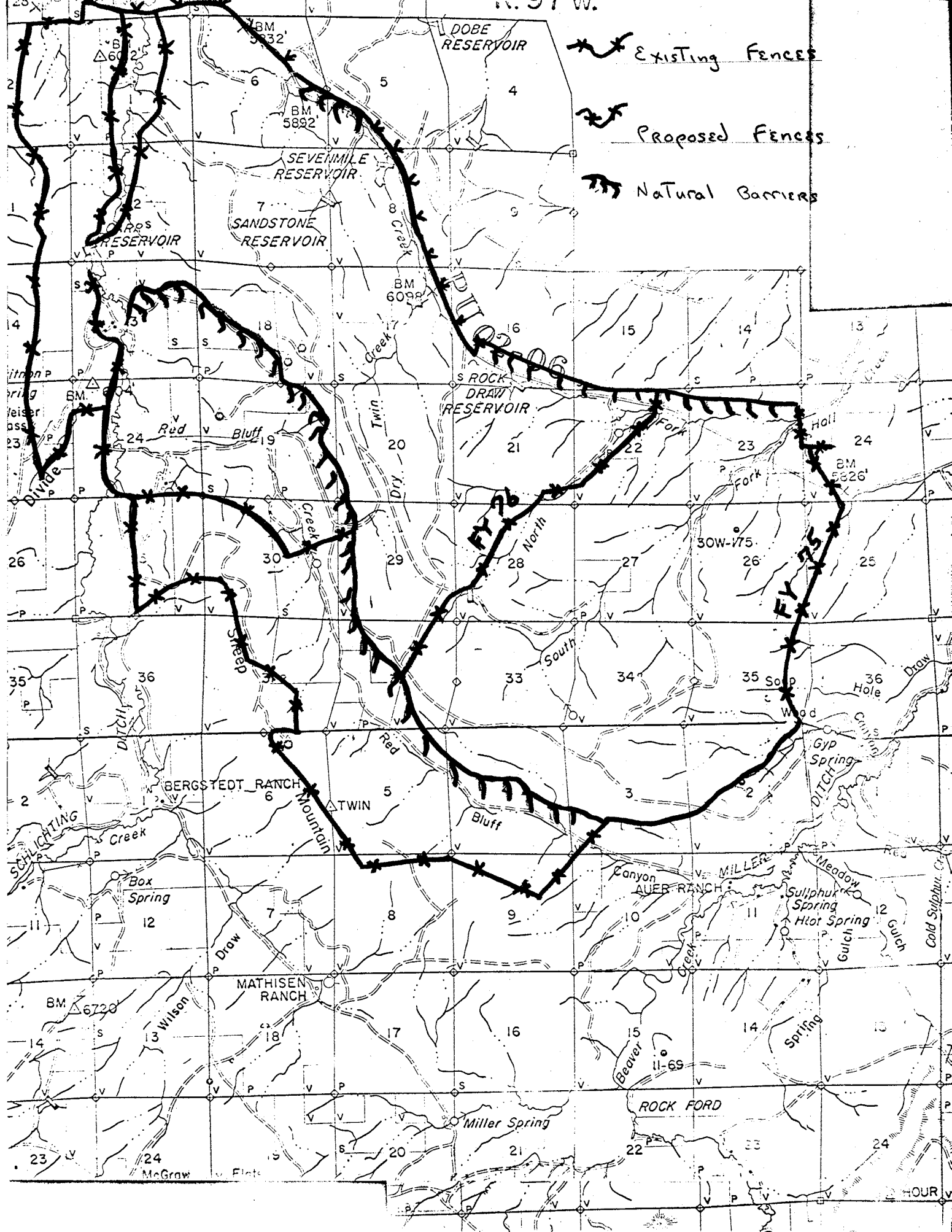

Save Energy and You Serve America!



-  Existing Fences
-  Proposed Fences
-  Natural Barriers

BM 5832

DOBE RESERVOIR

SEVENMILE RESERVOIR

SANDSTONE RESERVOIR

ROCK DRAW RESERVOIR

BERGSTEDT RANCH

MATHISEN RANCH

ROCK FORD

WILSON

FR 76

FR 55

Divide

Red Bluff

Twin Creek

Sheep Creek

South

Gyp Spring

Schlichting Creek

Box Spring

Twin Mountain

Bluff

Canyon AUER RANCH

Sulphur Spring

Hot Spring

BM 6720

Wilson

Beaver

Miller Spring

Spring

McGraw

HOURLY