

PARADISE
OUTFITTERS

501 MAIN STREET
BELLWOOD, PA 16617



Bud Lilly
2007 Sourdough Rd
Bozeman MT 59715

LILL007 597152031 1102 07 05/03/02
NOTIFY SENDER OF NEW ADDRESS
LILLY
13013 FRONTAGE RD
MANHATTAN MT 59741-8026

59715+5274 13

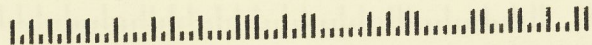

How far would you travel for trout this BIG?

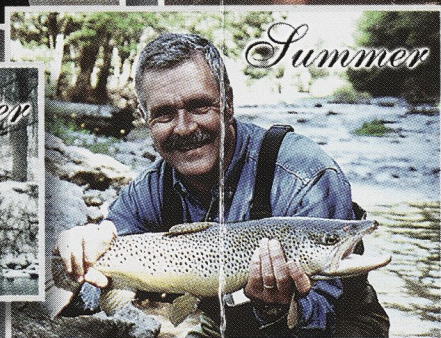
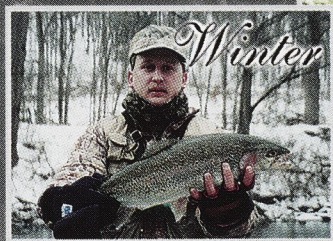
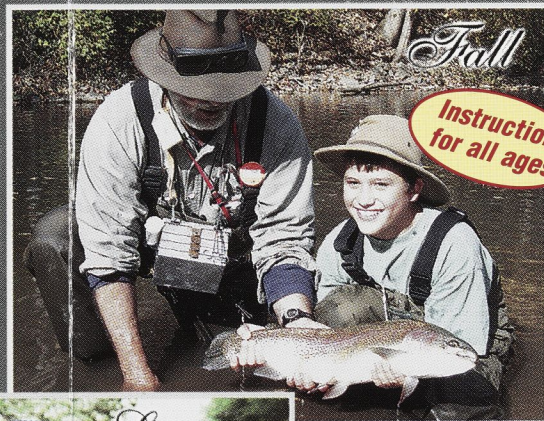
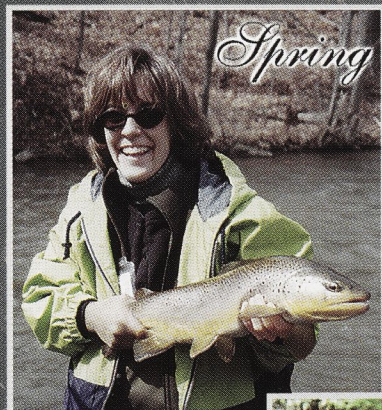

ORVIS
ENDORSED
FLY-FISHING
OUTFITTER

Featuring
Private Waters
on Spruce Creek
& Penns Creek

PARADISE — just a few smiles away.

City	Drive Time
Pittsburgh	2.5 hours
Washington	2.9 hours
Philadelphia	3.2 hours
Cleveland	3.6 hours
NYC	3.9 hours

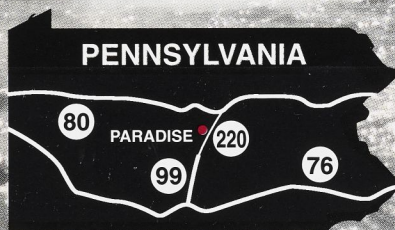

1-800-282-5486

PARADISE OUTFITTERS • JULIAN, PA 16844
WWW.FLYFISHPARADISE.COM

You don't have to travel far to catch huge, wild trout.

Professional Guides

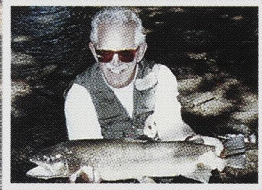
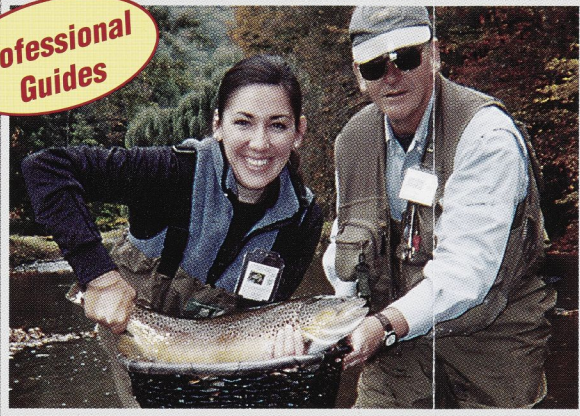

Here's what the experts are saying...

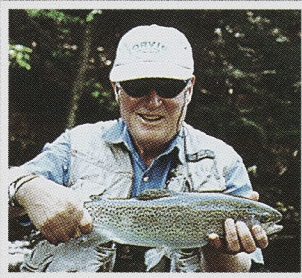

Leigh Perkins
Chairman of the Board
The Orvis Company

“The trout fishing in the Spruce Creek area is to my knowledge the finest east of the Rockies. Paradise has joined the finest of these waters with some of the very best fly fishing guides.”

“Paradise Lodge rivals anything in the legendary trout states of the American West. Fortunately, the angling is as good as the lodging.”



Michael Pearce
From his April 23, 2001 Wall Street Journal article titled, *“For Once, the Big One Didn't Get Away”*

“Donny Beaver, who owns Paradise Lodge ... thinks flyrodders are sticking closer to home in these troubled times. This logic gets no argument from me. We packed a lot into our day, have pictures to prove it, and were home in time to catch the end of the Wizards game. Hmmm. Maybe Michael Jordan should take up fly fishing.”

Angus Phillips, Washington Post, November 11, 2001

Why do the trout grow so large in Paradise?

- We practice strict Catch-and-Release fly fishing on blue-ribbon waters.
- We limit the number of anglers on some of the most-productive private limestone spring creeks in the U.S.

1-800-282-5486 • WWW.FLYFISHPARADISE.COM
PARADISE OUTFITTERS • JULIAN, PA 16844

Featuring
Private Waters
on Spruce Creek
& Penns Creek

PARADISE OUTFITTERS

Dear Fly Fishing Friend,

Good day. It's Josh Beaver again. You might remember, I wrote you a few weeks back (when I broke my ankle and was stuck in the office) urging you to join our Paradise Outfitters e-Mail Club (eClub). The whole idea of the Paradise eClub was to save time and money in our marketing communications. AND, because we would save, we wanted to reward folks who agreed to join.

As a Paradise E-Mail Club Member You'll Enjoy the Following Exclusive Benefits

- \$100 Credit to YOUR Account** to be used against any NEW trip scheduled from April 20 to November 30, 2002
- Latest "Hatch" Conditions.** eClub Members will have exclusive access to a special spot on our website that tells about the "What's Hatching."
- Feature Fly of the Month.** Most of you remember last August when my dad started sending a sample of a "feature" fly each month. We are going to resume the program for eClub Members ONLY.
- Discount on Trout Flies.** We've lined up overseas suppliers to tie trout flies to our exacting standards. Because labor is so much less, you can save up to 50% off trout flies. Exclusively available to eClub Members.
- Early-Bird Specials.** Paradise eClub Members will be the first to hear about any special promotions we offer.
- Last Minute Deals.** Sometimes we get last minute cancellations or just have some "left over" water or lodge rooms available. As an eClub Member, you will have access to these deals that can save you big bucks.
- You can QUIT any time you wish.** If you do not like getting E-mail pictures of big trout, saving money on trout flies and trips, simply tell us to stop sending you E-mails and we will stop immediately. GUARANTEED.

The good news is that over 20% of the folks on our "snail mail" (USPS) list responded and joined Paradise eClub. Dad tells me that it's the best response we have ever gotten to a mailer in 27 years of business.

The not-so-good-news is that 80% DID NOT JOIN the eClub. And, YOU are one of the 80% who DIDN'T.

Now, maybe you don't want to get a \$100 credit in your account, or save up to 50% on trout flies, or learn about how you can save on last-minute trip cancellations. Heck, maybe you just hate email and don't want to be bothered. But remember, our eClub is pain free. 1) We will only enroll you if you ask - no unsolicited junk AND 2) You can quit anytime you wish (just tell us and we'll stop.) What could be easier?

If you want to join the Paradise eClub just call at 1-800-282-5486 and we'll take the information over the phone. OR, simply go to our website www.flyfishparadise.com and click on the box at the lower middle of the home page that says "Join & Save - eClub" We'll get you registered in the club and you can start saving right away. What could be better?

Well, I'm off to finish up some stream bank reinforcement. Hope to see you on the water.

Josh Beaver

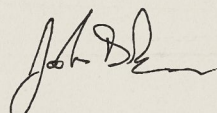

See What YOU are MISSING
Just flip this page to see what you will be missing by not joining Paradise eClub.

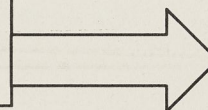

P.S. I ended up having surgery on my ankle (spiral fracture) and the doctor put a titanium plate with ten screws to patch me together. After seven long weeks I am finally able to throw my crutches away and get back to the "real" work (lots of stream improvement & repair projects on my list.)

P.P.S. Don't forget, the Paradise eClub officially kicks off on May 15, 2002. If you join before then, you get the \$100 credit to you "Future Trips" account. Don't wait. It's just around the corner.

P.P.S. While I was mowing the grass along the Little Juniata yesterday morning, the grannom caddis hatch was so strong that I got my daily dietary protein just from the bugs that flew in my mouth. Seriously, the water was boiling with trout (and only three guests had nearly two miles of river ALL TO THEMSELVES). Wish you were here.

Outfitting you to build lasting relationships.

Look What YOU are Missing

You are currently NOT a member of the Paradise Outfitters email club (eClub.)

So, what's the big deal you ask?????

Well, if you were a member, you would already have benefited from the following:

***\$100 Credit to your account for any trip planned from April 20 through November 30**

***Early Notification of some prime Mayfly dates that opened up this week**

***Last-Minute availability of blue-ribbon guided day-trips at 58% savings**

***Announcement of our new "Blind Dog" cottage on a Private section of Spruce Creek**

***Announcement of our Special Camp Little J packages
as low as \$89.50 per angler per day for lodging and
private property access pass to the Little Juniata below Spruce Creek**

***Summer Specials – Save 27%
PLUS get an extra day of fishing & meals
AND extra night's lodging absolutely FREE**

But, according to our records, you have NOT joined the Paradise eClub yet.

It's fast, it's easy, it's FREE. So, what's stopping you????

If you want to join the Paradise eClub just call at 1-800-282-5486 and we'll take the information over the phone. OR, simply go to our website www.flyfishparadise.com and click on the box at the lower middle of the home page that says "Join & Save – eClub" We'll get you registered in the club and you can start saving right away. What could be better?

Hurry

Join the Paradise eClub by May 15, 2002

And get a \$100 credit

That's good toward any new trip you schedule

Between now and November 30, 2002

See other side for more details →

Riverviewkeepers' Journal
and Calendar of Events

July 31, 2001 Salmon Dinner in let
Aug 1, 2001 moved box Friday

Aug 4, 2001 - Sweet Pea Saturday
Parade

August 5th; Grannyfatts Sunday

Senator Burns Picnic @ ranch
Monday

August 7th 2001 Tuesday
Fished ranch & Chris & Flint

August 8, 2001 Wednesday

8 a.m. Bkft mts &
American River
Re:

Lunch @ McGinnis'
on West Boulder

Thursday

Thursday

Friday
Sat

Lee Malloy Dinner Sun

Aug 2 - Joe Urbani &
Eric Peterson.

July Dick Westrick
News stories

July Gary Anderson
Minn. Vikings
Kicker. Prospect

July Lee Mallory site
Prospect. Inter-
national transport
company.

April - Forbes FYI - Paid
ABC News - Not



RIVERBEND
PUBLISHING

P.O. Box 5833
Helena, MT 59604

11501 511 12111111



U.S. POSTAGE
APR 12 2002
\$00.340
MAILED FROM ZIP CODE
59601

1ST CLASS



PITNEY BOWES

024P0007599407



Bud Lilly
2007 Sourdough Rd
Bozeman MT 59715-5874

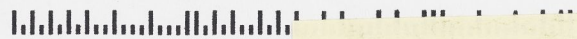

LILL007 597152032 1102 07 04/16/02
NOTIFY SENDER OF NEW ADDRESS
LILLY
13013 FRONTAGE RD
MANHATTAN MT 59741-8026

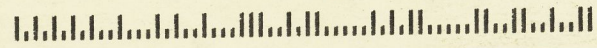

HELENA, MT
PM
12 APR
002

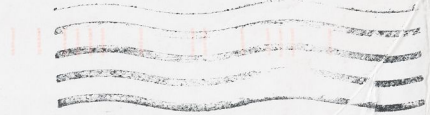



RIVERBEND
PUBLISHING

P.O. Box 5833
Helena, MT 59604
Ph 406.449.0200
Fax 406.449.0330
www.riverbendpublishing.com

April 12, 2002

Bud Lilly
2007 Sourdough Road
Bozeman, MT 59715-5874

Dear Bud,

This summer Riverbend will publish a small, 72-page photo book on Montana trout fishing. It will sell for \$14.95. Although primarily a photography book, it will include about a dozen short quotations from various sources to serve as commentary on the photos.

We want to include the following selection from your wonderful book, *Bud Lilly's Guide to Fly Fishing the New West*:

As long as I can remember, I was always engaged most by the instant of the strike.

You and your book will be credited, and we will pay you a \$75 honorarium upon publication. You also will receive two complimentary copies of the book.

If you are agreeable to this plan, please return the SASE to confirm that we have your correct address for paying the honorarium and for sending you the complimentary book. (If we don't, please correct your address on the copy of this letter and return it.) Or if it is easier, simply contact me by phone, fax, or email. Thank you.

Sincerely,

Chris Cauble
President

Ccauble@riverbendpublishing.com



Sleepy Hollow Lodge
PO Box 1080
West Yellowstone, MT 59758

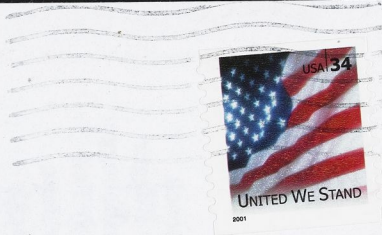
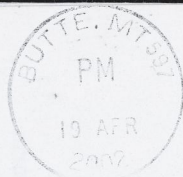

2002 SPRING FISHING NEWS

LILL007 597152032 1102 07 04/22/02
NOTIFY SENDER OF NEW ADDRESS
LILLY
13013 FRONTAGE RD
MANHATTAN MT 59741-8026

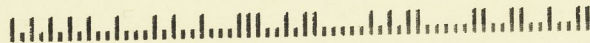

SLEEPY HOLLOW LODGE

124 Electric St., PO Box 1080, West Yellowstone, MT 59758

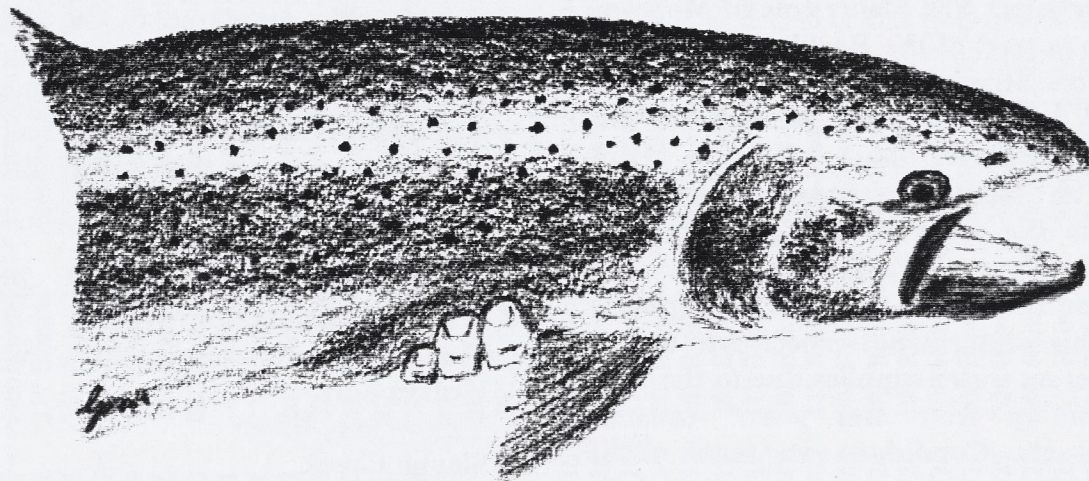

2002 SPRING FISHING NEWS

HIGHLIGHTS OF LAST SEASON

Spring run-off was a non-event with the lower than normal snowpack and as a result early season fishing got a quick start. Most waters in the area came through the season well. The Firehole River was warmer than usual in June and Henrys Lake was dropped lower than normal for irrigation needs.

With lower than normal snowpack, fires were always a threat, but some welcome rains and cold fronts came just when needed in July. As a result, the nearest fires of any consequence were 100 miles or more away.

The star producer continues to be the Madison River system, including Hebgen Lake, with the Henrys Fork coming in a close second. Population studies on the Madison below Quake Lake show a strong increase in younger fish, which bodes well for the near term. Reports from our guests on this section of the Madison show a corresponding increase in larger trout over 18 inches as well. Caddis continue to be the most productive patterns here, and there is an increasing move to small nymphs in sizes 18 and up as the season progresses. These seem to account for the largest trout.

A place where one could fish from May through October and have continuous action with larger trout is Hebgen Lake. This has to be the most dependable fishing in the area and includes a long stretch from June into early September for surface activity and dry fly action. These surface feeding trout are mostly rainbows, averaging 18-20 inches. Browns are here as well, ranging up to well over 20 inches, and are mostly caught with subsurface flies. A float tube or boat is always an advantage, but there are locations accessible to the wading angler too.

The same fish Hebgen Lake anglers enjoy in the summer run up into the upper Madison River in the fall. The fishing this past fall continued the high level of last year and was if anything better. Sizes ran larger this year too with more fish reported over 20 inches. As usual rainbows slightly outnumbered the browns. Interesting to note that more anglers are using unweighted wet flies, mostly soft-hackles. Easier to cast and fish on the down-and-across swing, they seem to be as effective as any other method, especially on quieter and slower waters. Steve Miller released the biggest this year, a 27" brown caught on a crystal buggler with flashy black crystal chenille body.

2002 FORECAST

Snowpack this past winter was much better than last year in our area. The plains area of Montana and the southern part of the Rockies did not fare as well, however. Streamflow forecasts as of April 1 are 70-90% of the 30 year average for the Madison, Yellowstone and Henrys Fork watersheds. The Gallatin is estimated at less than 70%. This is the same as last year for the Madison and Henrys Fork, more for the Yellowstone and less for the Gallatin. The greater snowpack of this winter is not expected to have a stronger impact on water supplies due to the need to play catch up from last years' reduced groundwater levels. Conditions over much of the northwest are improved over last year, especially northwest Montana, Washington, Oregon and northern Idaho.

Greater snowpack in our area should result in a more normal runoff pattern this spring, most of it coming in June. Henrys Fork will probably not have much runoff effect due to the need to fill Island Park Reservoir, seriously depleted last year. Henrys Lake is expected to fill to 80% of capacity, which is reasonable considering last years' drawdown. Population figures on the Madison below Quake Lake are healthy for smaller fish and the trend is up for all age brackets. The Whirling Disease and fishing pressure impacts on fish populations seem to have stabilized or reduced through natural processes and the fish have responded.

The excellent fishing from last year should continue on the Madison, Hebgen Lake, and Henrys Fork. The Yellowstone and its watershed including Slough Creek should have increased flows. Hebgen Lake retained a normal level last year and this should continue. The rainbow and brown trout population in Hebgen is expected to hold at a high level and this will drive the lake gulper fishing and the fall spawning run at another high rate.

BIG FISH LIST

Fish caught and released 20"+ increased considerably compared to the last several years. Most of these were from Hebgen Lake and the fall spawning run on the upper Madison River. The lower Madison also improved in all sizes over 18". It should be noted that not all fish are reported, especially those 18"-19".

	<u>18-19"</u>	<u>20"+</u>
Madison River (Lower)	34	9
Madison River (Upper)	47	51
Henrys Fork	1	8
Yellowstone River	1	2
Slough Creek	1	1
Henrys Lake	5	1
Hebgen Lake	47	13
Gallatin River	1	1
Other rivers	-	2
TOTALS	137	88

\$3 BRIDGE PROJECT

An 800 acre parcel of land on the Madison River below Quake Lake surrounds arguably the most productive part of the river. The owners have listed the property for sale and the conservation group River Network has led a major effort to purchase it to preserve public access. This is the Candlestick Ranch, otherwise known to anglers as the Three Dollar Bridge access site.

The first step to securing this property for the future was successful with the acquisition of a purchase option. Many of us here and across the nation helped raise funds for this effort. The next phase is an even greater effort and River Network has enlisted the help of Orvis, Trout Unlimited, the National Fish and Wildlife Foundation, Montana Fish, Wildlife and Parks, and others. River Network and Orvis have organized a 3:1 challenge grant arrangement where each contribution triples in value. The last page of this newsletter lists addresses for these organizations in this most worthy project.



2001 CATCH AND RELEASE BIG FISH LIST



Jim Gearde	5/17	20" Rainbow	Hebgen Lake	Woolly Bugger	Bob Leasure	9/16	20" Rainbow	Madison R. (U)	SH Peacock
Craig Fanos	5/18	21" Rainbow	Hebgen Lake	Woolly Bugger	Bob Leasure	9/18	20" Rainbow	Madison R. (U)	Woolly Bugger
Craig Fanos	5/18	20" Brown x2	Hebgen Lake	Woolly Bugger	Charlotte Smith	9/21	20" Rainbow x2	Madison R. (U)	BH Flashabugger
Lew Squires	6/2	23" Rainbow	Henrys Fork	Hemingway Caddis	David Leaf	9/22	21" Brown	Madison R. (L)	Pheasant Tail
David Dieter	6/17	20" Rainbow	Henrys Fork	Pale Morning Dun	Arlene Marcus	9/25	20" Rainbow	Madison R. (U)	Copper John
David Dieter	6/17	22" Rainbow	Henrys Fork	Pale Morning Dun	Dave Gill	9/27	20" Brown	Madison R. (U)	Soft Hackle
David Dieter	6/19	21" Rainbow	Henrys Fork	Flav	Dave Gill	9/30	22" Brown	Madison R. (U)	Soft Hackle
Bob Leasure	6/22	20" Rainbow	Henrys Fork	Rusty Spinner	Dave Gill	9/30	20" Brown	Madison R. (U)	Soft Hackle
Brian Tucholke	6/27	20" Rainbow	Madison R. (L)	Black Stone Nymph	Scott Burns	9/30	22" Brown	Madison R. (U)	Soft Hackle
William Leed	7/3	20" Rainbow	Henrys Fork	Flav	Scott Burns	10/1	20" Rainbow	Madison R. (U)	BH Bugger
Rick Snyder	7/8	20" Rainbow x2	Henrys Fork	Pale Morning Dun	Scott Burns	10/1	21" Brown	Madison R. (U)	Prince
Don Schick	7/9	24" Cuttbow	Henrys Lake	Callibaetis	Cheryl Gill	10/2	20" Rainbow	Madison R. (U)	Soft Hackle
Rick Carter	7/10	21" Rainbow	Madison R. (L)	Girdle Bug	Pat Carroll	10/3	22" Rainbow	Madison R. (U)	Spruce
Phillip Naro	7/15	20" Brown	Madison R. (L)	Serendipity	Pat Carroll	10/3	20" Brown x2	Madison R. (U)	Bitch Creek
Phillip Naro	7/15	20" Rainbow	Madison R. (L)	Serendipity	Bob Carpenter	10/8	20" Brown	Madison R. (U)	San Juan Worm
David Rogers	7/17	20" Brown	Madison R. (L)	Zonker	Gary Gardner	10/8	22" Brown	Madison R. (U)	Soft Hackle
Dan Wojic	7/25	20" Brown	Madison R. (L)	Elkhair Caddis	Dave Gill	10/9	21" Brown	Madison R. (U)	Partr. & Orange
Tom Prusak	7/25	20" Cutthroat	Yellowstone R.	Elkhair Caddis	Dave Gill	10/9	20" Rainbow	Madison R. (U)	Partr. & Orange
Don Schick	7/23	20" Brown	Madison R. (L)	Chocolate Emerger	Dave Gill	10/10	20" Rainbow	Madison R. (U)	Partr. & Orange
Don Schick	8/1	20" Rainbow	Hebgen Lake	Callibaetis	Steve Miller	10/14	27" Brown	Madison R. (U)	New Age CB
Frank Nugent	8/1	20" Rainbow	Hebgen Lake	Callibaetis	Joe Lovas	10/16	20" Brown	Madison R. (U)	Partr. & Orange
Joe Lovas	8/8	20" Rainbow	Hebgen Lake	Callibaetis	Bill Simons	10/16	20" Brown	Madison R. (U)	Partr. & Orange
Joe Lovas	8/8	20" Cutthroat	Yellowstone R.	X Caddis	Steve Miller	10/16	21" Brown	Madison R. (U)	Conehead JJ Spec.
Dave Ford	8/12	22" Rainbow	Hebgen Lake	Callibaetis	Charlotte Smith	10/17	21" Brown	Madison R. (U)	BH Flashabugger
Dave Ford	8/12	20" Rainbow	Hebgen Lake	Callibaetis	Larry Miller	10/17	20" Rainbow x2	Madison R. (U)	Fuzzy Navel
Bob Koehne	8/14	20" Rainbow	Hebgen Lake	Callibaetis	Joe Ojea	10/17	20" Brown	Madison R. (U)	Partr. & Orange
Bob Koehne	8/15	20" Rainbow x2	Hebgen Lake	Callibaetis	Frank Croft	10/17	21" Brown	Madison R. (U)	Dark Spruce
Larry Miller	8/18	20" Rainbow	Hebgen Lake	Bibiou Ant	Steve Miller	10/17	20" Rainbow x3	Madison R. (U)	Conehead JJ Spec.
Steve Wilson	8/30	21" Rainbow	Hebgen Lake	Para-Adams	John Kearney	10/18	21" Rainbow	Madison R. (U)	Eager Beaver
Doug Little	9/1	21" Cuttbow	Slough Cr. (L)	Beetle	Steve Miller	10/18	20" Rainbow	Madison R. (U)	Conehead JJ Spec.
Wiley Johnson	9/1	20" Cutthroat	Gallatin R.	BH Pheas. Tail	Bill Simons	10/20	20" Brown x2	Madison R. (U)	Partr. & Orange
J.F. Tucker	9/1	20" Rainbow	Madison R. (L)	Serendipity	Rick Snyder	10/24	20" Rainbow	Madison R. (U)	BH Partr. & Or.
Dan Freeman	9/2	20" Whitefish	Madison R. (L)	BH Pheas. Tail	Larry Miller	10/26	20" Rainbow x3	Madison R. (U)	SHPT, P&Orange
Ray Lewis	9/3	20" Rainbow	Madison R. (U)	Golden Stone	Rick Urbauer	10/27	20" Brown	Madison R. (U)	Glo-Bug
J.F. Tucker	9/4	22" Brown	Missouri R.	BH Nymph	Tom Ishkanian	10/27	22" Brown	Madison R. (U)	Glo-Bug
Wiley Johnson	9/4	20" Brown	Missouri R.	Hopper	Larry Miller	10/27	20" Rainbow x2	Madison R. (U)	Fuzzy Navel
Larry Miller	9/5	20" Rainbow	Madison R. (U)	Partr & Green	Larry Miller	10/29	21" Rainbow	Madison R. (U)	Fuzzy Navel
Al Barnes	9/8	20" Rainbow x2	Madison R. (U)	BH Hares Ear	Larry Miller	11/3	20" Brown	Madison R. (U)	Partr. & Orange
Gil Caviedes	9/16	20" Rainbow	Madison R. (U)	SH Peacock	Larry Miller	11/4	20" Rainbow	Madison R. (U)	Partr. & Orange



Madison R. (U)= Above Hebgen Lake (L)= Below Hebgen Lake

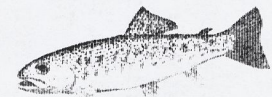



Sleepy Hollow Lodge
PO Box 1080
West Yellowstone, MT 59758

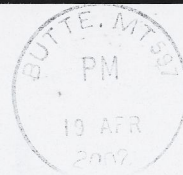

2002 SPRING FISHING NEWS

LILL007 597152032 1102 07 04/22/02
NOTIFY SENDER OF NEW ADDRESS
LILLY
13013 FRONTAGE RD
MANHATTAN MT 59741-8026

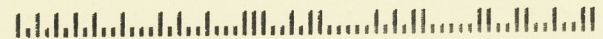

ORGANIZATIONS SUPPORTING FISHERIES

The following organizations are actively supporting fisheries projects in our area:



Federation of Flyfishers, PO Box 1595, Bozeman, MT 59771

Greater Yellowstone Coalition, PO Box 1874, Bozeman, MT 59771

Henrys Fork Foundation, PO Box 61, Island Park, ID 83429

Henrys Lake Foundation, 15200 NW Burlington Court, Portland, OR 97231

***Madison Gallatin Wild Trout Foundation, PO Box 945, West Yellowstone, MT 59758**

Montana Trout Foundation, PO Box 3165, Bozeman, MT 59722

***Orvis, \$3 Bridge Project, Historic Rt. 7A, Manchester, VT 05254**

***River Network, 44 N. Last Chance Gulch #4, Helena, MT 59601**

***Trout Unlimited, \$3 Bridge Project, 1500 Wilson Blvd. #310, Arlington, VA 22209**

The Yellowstone Park Foundation, 109 E. Main, Suite 2, Bozeman, MT 59715

Whirling Disease Foundation, PO Box 327, Bozeman, MT 59771-0327

*** Three Dollar Bridge Project direct participants**

Accessing Sleepy Hollow for reservations or information, you can reach Charlotte or Larry at:

Sleepy Hollow Lodge
124 Electric St., PO Box 1080
West Yellowstone, MT 59758
406-646-7707
e-mail: sleepyhollow@wyellowstone.com

Or visit our web site: www.sleepyhollowlodge.com



May 12, 2008

Esther,

enclosed is the information on the Logan Property. Please feel free to contact me with any questions or concerns you may have.

Thank you for your interest.

Sincerely,

Michael Rina
580-4252

522-9378

NW 1/4, SEC. 36, T2N, R2E

SCALE 1" = 200'

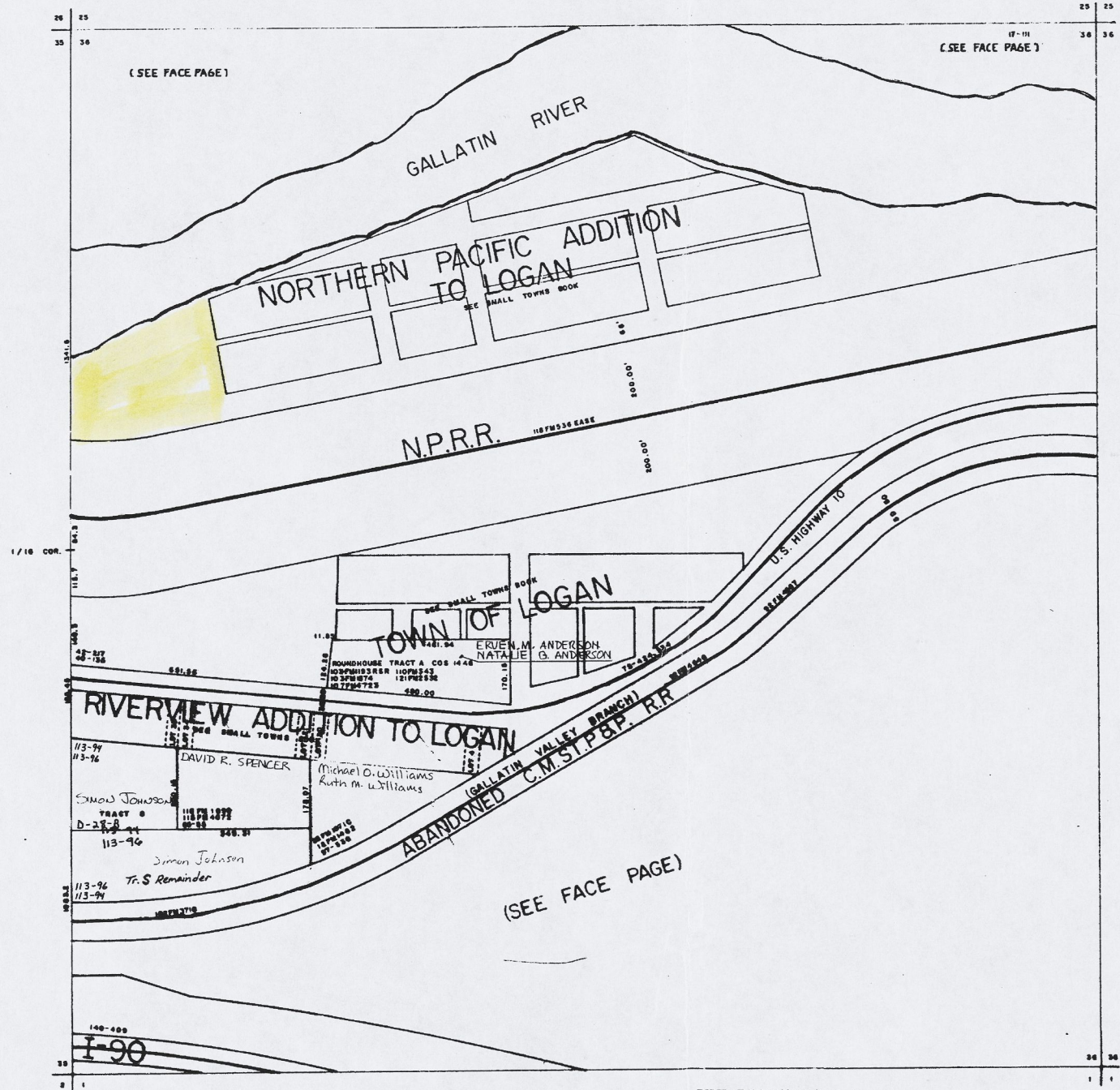

DISCLAIMER: This plot is a visual representation only and does not represent a survey. No liability is assumed as to the accuracy delineated hereon.

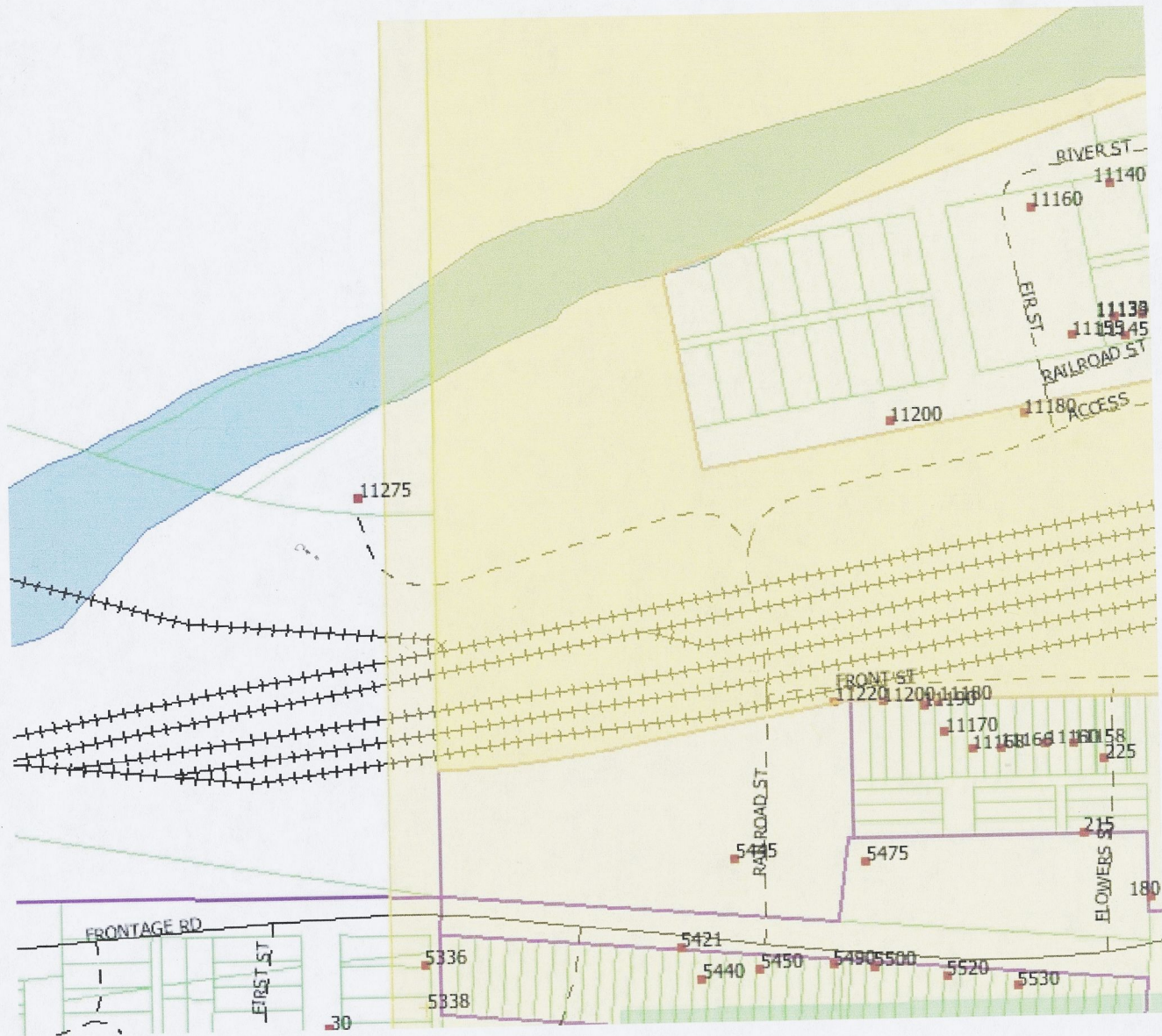

BERG, LILLY, ANDRIOLO & TOLLEFSEN

A PROFESSIONAL CORPORATION

ATTORNEYS AT LAW

MICHAEL J. LILLY
RICHARD J. ANDRIOLO
GIG A. TOLLEFSEN
RIENNE H. McELYEA
C. BRUCE COMBS
DANIEL P. BUCKLEY

ADVANCED TECHNOLOGY PARK
910 TECHNOLOGY BLVD.
SUITE A
BOZEMAN, MT 59715

OF COUNSEL:
BEN E. BERG, JR.

TELEPHONE: (406) 587-3181
FAX: (406) 587-3240

February 21, 1995

Mr. Bud Lilly
2007 Sourdough Road
Bozeman, MT 59715

Re: Estate

Dear Dad:

Please find enclosed the following:

1. Check from Kit in the amount of \$130.00 for February rent.
2. February power bill.
3. Copy of correspondence from VICA Company.

There is no need for me to receive the power bill or Kit's checks any longer. As a result, I suggest you call the power company and have them change the address on the account. I have written to Kit and told her to send the checks directly to you.

Please let me know your reaction to the VICA Company correspondence. We will then make a decision on how to proceed.

Thanks.

Sincerely,

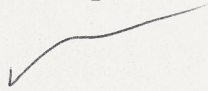
Michael J. Lilly

MJL:lj
Enclosures

Norman A. Lamb, President
David W. Lamb, Vice-President
James E. Brousseau, Secretary-Treasurer

Telephone
(916) 284-6191

VICA Company

INCORPORATED IN CALIFORNIA, FEBRUARY 20, 1919

117 Crescent Street
P.O. Box 778
Greenville, California 95947-0778

February 7, 1995

Mr. Michael J. Lilly
Berg, Lilly, Andriolo & Tollefsen,
Attorneys at Law
910 Technology Blvd., Suite A
Bozeman, MT 59715-4000

RECEIVED
FEB 13 1995

THE BERG LAW FIRM

Re: Certificate #1231 for 10 shares
of VICA Company formerly Virden
Packing Company issued in the
name of W.F. Lilly on September
13, 1920.

Dear Mr. Lilly:

This is in reply to your letter of February 3rd regarding
the above shares of this Company.

Please be advised that these shares were escheated to the
State Controller, State of California, on May 8, 1980, pursuant
to Section 1500 et seq., Code of Civil Procedure "Unclaimed
Property Law."

To redeem the shares, please write to the State Controller
at the following address:

Controller of the State of California
Division of Unclaimed Property
P.O. Box 942850
Sacramento, CA 94520-5673

If action is not taken to redeem these shares, they may be sold
by the State of California.

For your information enclosed please find a copy of our
current Corporate Information Statement.

The Company is agreeable to purchasing these shares at
\$5.00 per share after they have been redeemed.

If you have any questions, please contact me.

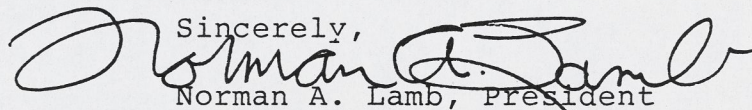
Sincerely,

Norman A. Lamb, President

Encl.

MEMBER: CALIFORNIA INDEPENDENT PRODUCERS ASSOCIATION

CORPORATE INFORMATION STATEMENT

Pursuant to Rule 15c2-11 of the Exchange Act

DATE: Mary 25, 1994

IRS #94-6109615
CUSIP #925598 10 4

I. NAME OF ISSUER

VICA COMPANY

II. ADDRESS

The office of the Company is 117 Crescent Street, P. O. Box 778, Greenville, California 95947. (Telephone 916 284-6191)

III. INCORPORATION

VICA Company was originally incorporated under the laws of the State of California on February 20, 1919, under the name of Virden Packing Company. On June 7, 1935, the Articles of Incorporation were amended to change the corporate name to VICA Company.

IV. CAPITALIZATION

The Company is capitalized for 100,000 shares of capital \$25.00 par value stock. There is only one class of stock and each share has the same rights and privileges as every other share. All stock shares equally in any dividend or distribution of assets.

V. ISSUED AND OUTSTANDING STOCK

VICA Company has issued and outstanding as of the date of this report, 34,997 of its shares. A total of 13 shares are held as treasury stock. The stock is distributed among approximately 901 shareholders. There are no options, warrants or rights outstanding, nor does the Company anticipate issuing any.

VI. TRANSFER AGENT

The transfer agent for the Company is Securities Registrar and Transfer Corporation with offices at 117 Crescent Street, P. O. Box 778, Greenville, California 95947. (Telephone 916 284-6191) The transfer agent has a supply of stock certificates on hand and will transfer shares upon request and keep a registry of them. The transfer agent charges \$8.00 per certificate for such services. The transfer agent registered as such on December 1, 1975, under the requirements of the Securities Reform Act of 1975 and is registered to make reports to and inquiries of the lost, stolen, missing and counterfeit securities information system.

VII. NATURE OF ISSUER'S BUSINESS

The Company owns 80 percent of the oil and gas rights under 640 acres comprising Section 16, Township 27 South, Range 23 East in the Semitropic Oil Field, Kern County, California, and is entitled to a gross royalty of 13.3334 percent of oil and gas production. In 1982 Gary Drilling Company of Bakersfield, California, completed VICA #1, VICA #2 and VICA #3 in the Northeast Quarter of the section as oil wells. All wells are marginal producers from the Randolph zone at approximately 7,500 feet in depth. In early 1990, Gary Drilling Company sold its interest in these wells to Semitropic Development Company et al of Bakersfield, California. Other geologic oil targets in Section 16 include the McLure-Cahn-Monterey Stevens zone at 10,500 feet and the Vedder zone at 18,000 feet. The Company leased 520 acres which is the balance of Section 16 to Semitropic Development Company et al in August, 1990. They drilled and completed VICA #4 as a gas well from the Mya zone at approximately 3,000 feet in October.

VIII. BOARD OF DIRECTORS

Norman A. Lamb - President and Director
P. O. Box 778, Greenville, California 95947

David W. Lamb - Vice-President and Director
547 Rollinhills Lane, Danville, California 94526

James E. Brousseau - Secretary-Treasurer and Director
270 Peppercorn Court, Vallejo, California 94591

Norman A. Lamb is a mining executive and an officer and director of several mineral holding companies

David W. Lamb is an account executive with General Mills, Inc. and a director of several mineral holding companies.

James E. Brousseau is a mining executive and an officer and director of several mineral holding and exploration companies.

IX. SECURITIES OWNERSHIP OF OFFICERS DIRECTORS AND CONTROLLING PERSONS

Title	Beneficial Owner	Amount & Nature	Percent
Capital Stock Par Value \$25. per share	James E. Brousseau	153 shares owned of record	*
	David W. Lamb	1 share owned of record	*
	Norman A. Lamb	4,326.5 shares owned of record	12.37%
	Beatrice F. Presant	4,120 shares owned of record	11.78%
	Daniel J. Weston	1,962 shares owned of record	5.61%

*Less than 1%

X. FINANCIAL STATEMENTS

The financial statements for the years ending December 31, 1993, 1992 and 1991 are attached and made a part of this Corporate Information Statement.

XI. BROKER DEALER

To the knowledge of the management of the Company, any quotation being submitted or published would be on behalf of the broker/dealer.

DATED at Greenville, California, this 25th day of May, 1994.

VICA COMPANY

By:

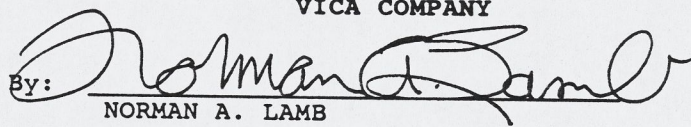
A handwritten signature in cursive script, appearing to read "Norman A. Lamb", written over a horizontal line.

NORMAN A. LAMB
President

*Cupit, Milligan,
Ogden & Co.*

————— *Certified Public Accountants*

VICA COMPANY
(A California Corporation)

FINANCIAL STATEMENTS

DECEMBER 31, 1993

VICA COMPANY
DECEMBER 31, 1993

TABLE OF CONTENTS

	<u>PAGE NO.</u>
ACCOUNTANTS' REPORT	1
FINANCIAL STATEMENTS	
Balance Sheets	2
Statements of Income and Accumulated Deficit	3
Statements of Cash Flows	4
Notes to Financial Statements	5-7

*Cupit, Milligan,
Ogden & Co.*

Certified Public Accountants

To the Board of Directors of
Vica Company
(A California Corporation)

We have compiled the accompanying balance sheets of Vica Company (a California corporation) as of December 31, 1993 and 1992, and the related statements of income and accumulated deficit and cash flows for each of the three years in the period ended December 31, 1993, in accordance with Statements on Standards for Accounting and Review Services issued by American Institute of Certified Public Accountants.

A compilation is limited to presenting in the form of financial statements information that is the representation of management. We have not audited or reviewed the accompanying financial statements and, accordingly, do not express an opinion or any other form of assurance on them.

Cupit, Milligan, Ogden + Co.

Reno, Nevada
April 4, 1994

VICA COMPANY
BALANCE SHEETS
DECEMBER 31, 1993 AND 1992
(See Accountants' Report)

ASSETS

	<u>1993</u>	<u>1992</u>
CURRENT ASSETS		
Cash and cash equivalents	\$ 11,223	\$ 45,345
Prepaid income tax	<u>500</u>	<u>2,676</u>
Total Current Assets	<u>11,723</u>	<u>48,021</u>
PROPERTY AND EQUIPMENT		
Office equipment	938	938
Less: Accumulated depreciation	<u>(938)</u>	<u>(938)</u>
Total Property and Equipment	<u>-</u>	<u>-</u>
OTHER ASSETS		
Marketable securities - Note 4	80,013	45,391
Allowance to reduce marketable equity securities to market - Note 4	(2,013)	-
Goldstone Mine limited partnership - Note 4	-	-
Mineral rights, net of accumulated depletion of \$14,132 in 1993 and 1992	<u>-</u>	<u>-</u>
Total Other Assets	<u>78,000</u>	<u>45,391</u>
Total Assets	<u>\$ 89,723</u>	<u>\$ 93,412</u>
LIABILITIES AND STOCKHOLDERS' EQUITY		
CURRENT LIABILITIES		
Accrued directors fees	\$ <u>1,500</u>	\$ <u>1,500</u>
Total Liabilities	<u>1,500</u>	<u>1,500</u>
STOCKHOLDERS' EQUITY		
Common stock, \$25 par value, 100,000 shares authorized, 34,997 shares issued and outstanding in 1993 and 1992	874,925	874,925
Treasury stock - Note 5	(100)	(100)
Paid-in-capital - Note 5	3,116	3,116
Accumulated deficit	<u>(789,718)</u>	<u>(786,029)</u>
Total Stockholders' Equity	<u>88,223</u>	<u>91,912</u>
Total Liabilities and Stockholders' Equity	<u>\$ 89,723</u>	<u>\$ 93,412</u>

The accompanying notes are an integral part of these financial statements.

VICA COMPANY
 STATEMENTS OF INCOME AND ACCUMULATED DEFICIT
 FOR THE YEARS ENDED DECEMBER 31, 1993, 1992 AND 1991
 (See Accountants' Report)

	<u>1993</u>	<u>1992</u>	<u>1991</u>
REVENUE			
Dividends	\$ 4,365	\$ 3,165	\$ 3,190
Interest	664	1,606	1,921
Royalties	3,664	12,120	41,585
Miscellaneous	<u>6</u>	<u>-</u>	<u>1,920</u>
Total income	<u>8,699</u>	<u>16,891</u>	<u>48,616</u>
OPERATING AND GENERAL EXPENSES			
Depletion	155	394	1,418
Legal and accounting	700	650	570
Management and director fees	4,500	5,100	5,100
Rent, telephone, and office expense	3,605	3,806	4,271
Taxes and licenses	1,807	3,500	1,044
Travel and per diem	<u>-</u>	<u>262</u>	<u>110</u>
Total operating and general expenses	<u>10,767</u>	<u>13,712</u>	<u>12,513</u>
Net income (loss) from operations before taxes	(2,068)	3,179	36,103
OTHER INCOME (EXPENSE)			
Gain on sale of assets	1,192	-	1,033
Unrealized loss on current marketable equity securities	<u>(2,013)</u>	<u>-</u>	<u>-</u>
Net income (loss) before taxes	(2,889)	3,179	37,136
Federal and California income taxes	<u>(800)</u>	<u>(866)</u>	<u>(7,065)</u>
Net income (loss)	(3,689)	2,313	30,071
ACCUMULATED DEFICIT, Beginning of year	<u>(786,029)</u>	<u>(788,342)</u>	<u>(818,413)</u>
ACCUMULATED DEFICIT, End of year	<u>\$(789,718)</u>	<u>\$(786,029)</u>	<u>\$(788,342)</u>
Earnings (Loss) Per Share	<u>\$ (.11)</u>	<u>\$.07</u>	<u>\$.86</u>

The accompanying notes are an integral part of these financial statements.

VICA COMPANY
STATEMENTS OF CASH FLOWS
FOR THE YEARS ENDED DECEMBER 31, 1993, 1992 AND 1991
(See Accountants' Report)

	1993	1992	1991
CASH FLOWS FROM OPERATING ACTIVITIES			
Net income (loss)	\$ (3,689)	\$ 2,313	\$ 30,071
Adjustments to reconcile net income (loss) to net cash provided (used) by operating activities:			
Depreciation and depletion	155	395	1,418
(Gain) loss on sale of securities	(1,192)	-	(1,033)
Unrealized loss on current marketable equity securities	2,013	-	-
(Increase) decrease in:			
Accounts receivable	-	-	4,618
Prepaid expenses	2,176	(2,676)	575
Increase (decrease) in:			
Accrued expenses	-	1,500	(3,000)
Taxes payable	-	(6,001)	5,813
Rental deposit	-	-	(1,920)
	(537)	(4,469)	36,542
CASH FLOWS FROM INVESTING ACTIVITIES			
Proceeds from sale of securities	103,715	-	8,866
Purchases of securities and investments	(137,300)	(8,544)	(3,940)
Net cash provided (used) by investing activities	(33,585)	(8,544)	4,926
Net increase (decrease) in Cash and cash equivalents	(34,122)	(13,013)	41,468
CASH AND CASH EQUIVALENTS, Beginning of year	45,345	58,358	16,890
CASH AND CASH EQUIVALENTS, End of year	\$ 11,223	\$ 45,345	\$ 58,358
SUPPLEMENTAL DISCLOSURE OF CASH FLOW INFORMATION			
Cash paid during the year for:			
income taxes	\$ 98	\$ 9,543	\$ 1,252

The accompanying notes are an integral part of these financial statements.

VICA COMPANY
NOTES TO FINANCIAL STATEMENTS
DECEMBER 31, 1993 AND 1992

NOTE 1 - SUMMARY OF SIGNIFICANT ACCOUNTING POLICIES

The Company's books are maintained on the accrual method of accounting.

Depreciation is computed using the declining balance method over lives ranging from five to ten years. Cost depletion on royalty trust investments is used.

For purposes of the statement of cash flows, the Company considers all highly liquid debt instruments purchased with a maturity of three months or less to be cash equivalents.

NOTE 2 - BACKGROUND OF THE COMPANY

VICA Company was incorporated in the State of California on February 20, 1919 as Virden Packing Company with authorized capital of 50,000 shares of \$100.00 par value (\$5,000,000). In 1921 the authorized capital was increased to 100,000 shares of \$100.00 par value (\$10,000,000). In 1931 the par value of the stock was reduced from \$100.00 to \$25.00. The name of the Company was changed on June 7, 1935 from Virden Packing Company to VICA Company. By amendment to the Articles of Incorporation the existence of the Company was made perpetual on October 17, 1969.

NOTE 3 - OIL, GAS AND MINERAL LEASE

Gary Drilling Company, Bakersfield, California sold its 120 acre lease from VICA Company in Section 16, Township 27 South, Range 23 East, M.D.M. & M., Kern County, California, to Semitropic Development Company et al, Bakersfield, California, in 1990. The Company leased 520 acres which is the balance of Section 16 to Semitropic Development Company et al. They drilled and completed VICA #4 as a gas well in October, 1990. The gross lease royalty is one-sixth (1/6) of which VICA Company receives 80 percent or 13.3334 percent of all oil and gas produced.

NOTE 4 - MARKETABLE SECURITIES

The Company owns 250 shares of Agey Petroleum Company and 1,000 shares of Caribou Oil Mining Company, small San Joaquin oil producers. There is no public market for shares of these companies. During 1993, Caribou paid a dividend of \$.015 per share and during 1992 paid a dividend of \$.015 per share.

The Company owns a limited partnership interest in Goldstone Mine Limited. Losses from the partnership have reduced the Company's basis to zero.

VICA COMPANY
 NOTES TO FINANCIAL STATEMENTS
 DECEMBER 31, 1993 AND 1992

NOTE 4 - MARKETABLE SECURITIES CONTINUED

	<u>1993</u>		<u>1992</u>	
	<u>Cost</u>	<u>Market</u>	<u>Cost</u>	<u>Market</u>
<u>Equity Securities</u>				
Agey Petroleum Company, 250 shares at December 31, 1993 and 1992	\$ 50	\$ -	\$ 50	\$ -
Caribou Oil Mining Company, 1,000 shares at December 31, 1993 and 1992	50	-	50	-
Coastal Corporation Cumulative Preferred H, 1,000 shares at December 31, 1993	25,000	25,000	-	-
Hugoton Gas Trust, 1,000 units at December 31, 1993 and 1992	4,913	8,500	5,067	8,500
Lasmo plc Cumulative Preferred A, 2,000 shares at December 31, 1993	50,000	44,500	-	-
Petroleum and Resources Corporation, 2,000 shares \$1.575 Convertible Preferred at December 31, 1992	-	-	31,680	38,500
Southern Security Life Insurance Company, 2,000 shares at December 31, 1992	<u>-</u>	<u>-</u>	<u>8,544</u>	<u>8,500</u>
Totals	<u>\$80,013</u>	<u>\$78,000</u>	<u>\$45,391</u>	<u>\$55,500</u>
Carrying value of investments at lower of cost or market	<u>\$78,000</u>		<u>\$45,391</u>	
Net unrealized gain (loss)	<u>\$(2,013)</u>		<u>\$10,109</u>	

VICA COMPANY
NOTES TO FINANCIAL STATEMENTS
DECEMBER 31, 1993 AND 1992

NOTE 5 - CAPITAL STOCK

The Company acquired 13 shares of treasury stock for \$100 prior to 1977, and carries these shares on the books at cost. The Company acquired seven shares of stock in 1980 for \$10, received a donation of one share in 1981, purchased one share in 1984 for \$10, purchased 35 shares in 1985 for \$45, purchased one share in 1986 for \$5, purchased ten shares in 1989 for \$50, and purchased 100 shares in 1990 for \$475. These purchases below par value are reflected as a reduction in shares outstanding at their par value of \$3,875. The excess of par value over cost has been credited to paid in capital from retirement of treasury stock, net of previous discounts.

NOTE 6 - INCOME TAXES

The Company incurred net operating losses of \$5,376 in 1993 and \$718 in 1992 for federal income tax purposes. These losses may be carried back and applied against taxable income for the three preceding tax years and carried forward for 15 years until used. The carryforward expires on December 31, 2008 and 2007 after which dates any remaining unused losses will be lost.

NOTE 7 - CONTINGENT LIABILITIES

The Company is not a defendant in any legal proceeding nor is there any litigation in progress, pending or threatened against the Company.

YELLOWSTONE HISTORIC CENTER

*P. O. Box 1299 · West Yellowstone, MT. 59758 · Phone/Fax 406-646-7461
History@wyellowstone.com*

Mr. Bud Lilly
2007 Sourdough Rd
Bozeman MT 59715
(406) 586-5140

Dear Mr. Lilly:

Maggie Merriman passed along to us the catch and release diorama for use in the fly-fishing exhibit. We would like to take this opportunity to thank you for lending us your artifacts.

Our mission at the Yellowstone Historic Center is to preserve and promote the cultural heritage of the Yellowstone area and experience. Outdoor activities have always been a cultural influence in this area but fly-fishing most specifically has shaped the way people live here to this day. We see this as expressed by our visitors who keenly enjoy the fly-fishing exhibit. The diorama you lent to us visually emphasizes the catch and release method that we have highlighted in our exhibit, and we are glad to have it on display.

Once again thank you for the loan; I have enclosed two loan agreement forms, one for you to sign and return to us in the envelope I have provided and one for your records.

Please feel free to call me at the museum if you have any questions regarding this paperwork: (406) 646-1100.

Lauren Smith
Registrar

Lender Copy

YELLOWSTONE HISTORIC CENTER

*P.O. Box 1299 · West Yellowstone, MT. 59758 · Phone/Fax 406-646-7461
History@wyellowstone.com*

July 14, 2001

TEMPORARY LOAN AGREEMENT

The objects described below, or on the attached pages, have been received by the Yellowstone Historic Center and are subject to the terms and conditions set forth.

*Mr. Bud Lilly
2007 Sourdough Rd
Bozeman MT 59715*

Objects on loan:

Fly fishing diorama with succors encased in plexi-glass. Original catch and release kit.

The objects above are on loan from Mr. Lilly to the Yellowstone Historic Center until November 2001.

The Yellowstone Historic center insures loan items for the entire period of the loan. The insurance value is based on the amount provided by the lender. The declared value of the object listed above is:

Please note that the said objects will not be loaned to other institutions without the written consent of the lender.

Signature of Lender: _____

For the Yellowstone Historic Center: _____

[Handwritten Signature]
Registrar

Fly fishing Reels

- 1 #1495 Pflueger Medalist
- 1 LRH Hardy Reel
- 1 Scientific Anglers Reel
- 1 Hardy Perfect Reel

Fly Box

- 1 Perrine fly box
- 1 leather fly book

Awards

Rod & Reel Guide of
the Year 1991

Governor of Montana
Whirling Disease Task
Force

Abseil Fly Reel U.S.A -
USSR Fly Fishing Exchange
1988

Catch & Release Pin. Release
from a stat with chain

Inventory Angler's All 2000
02/16/00

Books

Bud Lilly's Guide to Western
Fly Fishing

Bud Lilly's Guide to Fly Fishing
the New West

A Trout's Best Friend

The Kiplinger Sampler

Catalog + Map

Bud Lilly Catalog 1969, 1975
1977, 1978, 1981

Fishing Map - The Complete
Fishing Guide - by Bud Lilly

1 Split Willow Creef

1 fishing hat